

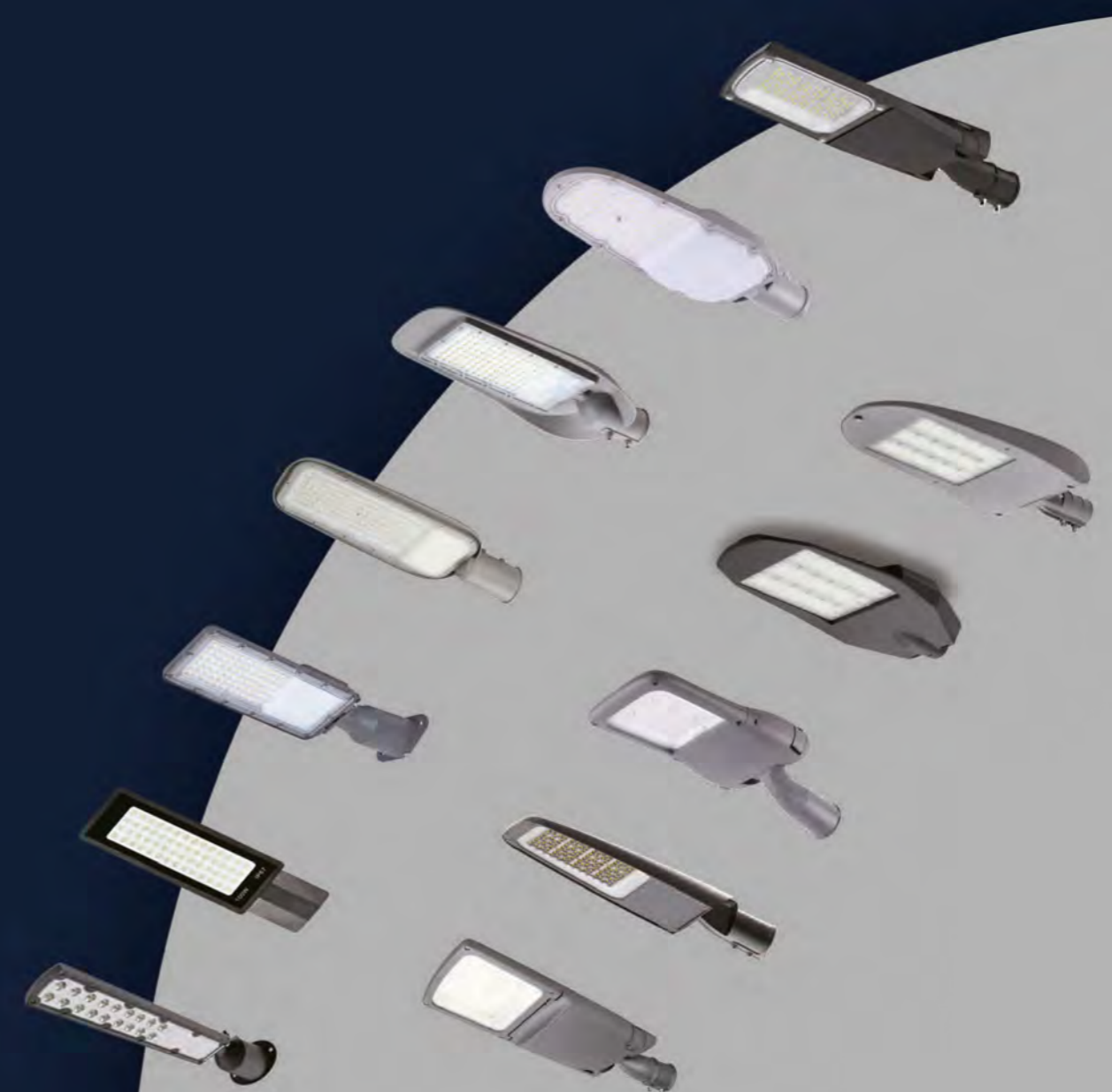

# LED Outdoor Lighting Catalog



# LED STREET LIGHT



## APPLICATIONS



## PRODUCT FEATURES

- Perfect replacement for traditional lights.
- Save 80% electricity cost, better efficiency, longer life span.
- Dedicated Ip65 sealed optical cavities.
- Optically optimized lenses.
- Uniformity in light distribution-maximizes efficiency.
- Fully operational in extreme weather up  $-35^{\circ}\text{C}$  to  $+55^{\circ}\text{C}$ .
- Low maintenance & Low power consumption.

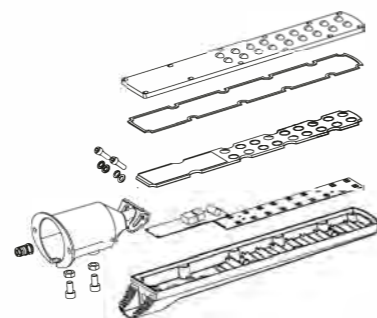

### Luminance Intensity Distribution

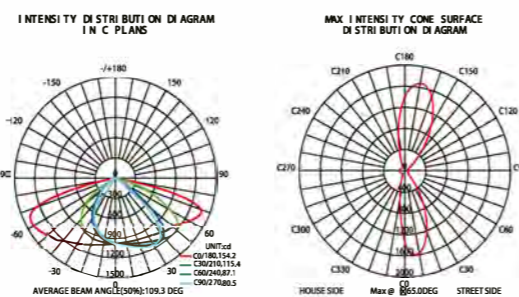

### Dimensions

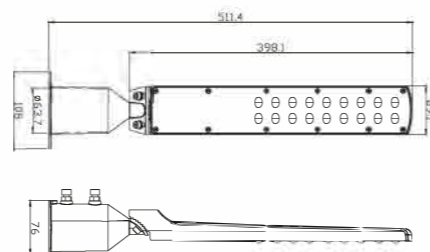

### KEY ADVANTAGES

- Cost-effective and efficient lighting solution
- Die-cast aluminium body for robust construction
- Lightweight & compact, easy to install
- Wide range of beam angles
- IP 65 tightness level, water-proof & dust-proof



### Product Parameter

|                        |  |         |          |
|------------------------|--|---------|----------|
| Model Name             |  |         |          |
| Power                  | 30W  | 50W     | 100W     |
| Driver Type            | DOB solution                                   |         |          |
| Light Source           | BRIGELUX/EPISTAR/SANAN/LUMILEDS/CREE(optional) |         |          |
| CCT                    | 2700-6500K                                     |         |          |
| Luminous Flux          | 3,600lm  | 6,000lm | 12,000lm |
| Luminous Efficacy      | 120lm/w  |         |          |
| CRI                    | ≥ 80Ra   |         |          |
| Light Distribution     | TYPE II (upon request)                         |         |          |
| Protection Class       | Class I  |         |          |
| Input Voltage          | AC180-265V                                     |         |          |
| Frequency              | 50/60HZ  |         |          |
| Power Factor           | 0.9  |         |          |
| Lifetime               | 30000H   |         |          |
| Surge protection       | 4KV(+10KV optional)                            |         |          |
| Material               | Die-cast Aluminium Body + PC Lens              |         |          |
| IP                     | IP65   |         |          |
| IK                     | IK08   |         |          |
| Inner Diameter Adaptor | φ 60mm   |         |          |
| Operating Temperature  | -25°C ~40°C                                    |         |          |
| Warranty               | 3 Years Warranty                               |         |          |



Luminance Intensity Distribution

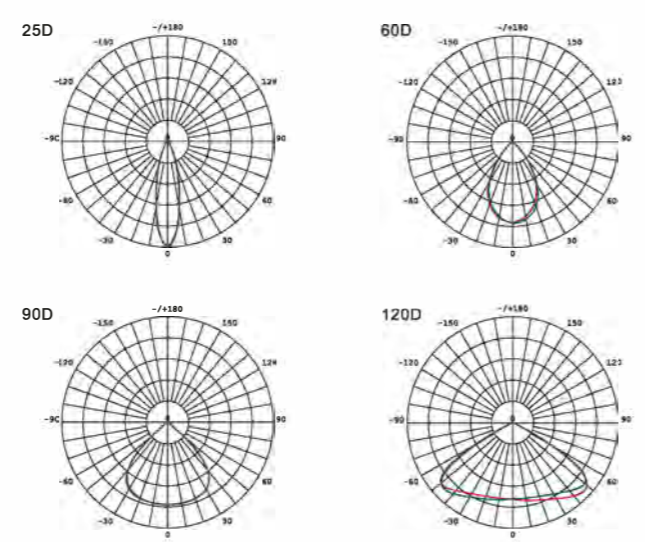

### KEY ADVANTAGES

- Cost-effective and efficient lighting solution
- Die-cast aluminium body for robust construction
- Optimized housing for better heat dissipation
- Four sizes for power 100W-300W, catering for different lighting needs
- IP 66 tightness level, water-proof & dust-proof

TWO YEARS  
**2**  
WARRANTY  
>120LM/W

### Product Parameter

|                       |  |             |             |             |
|-----------------------|--|-------------|-------------|-------------|
| Model Name            |  |             |             |             |
| Power                 | 100W   | 150W        | 200W        | 300W        |
| LED TYPE              | SMD3030/5050(optional)                         |             |             |             |
| Light Source          | BRIGELUX/EPISTAR/SANAN/LUMILEDS/CREE(optional) |             |             |             |
| Driver                | DOB solution                                   |             |             |             |
| CCT                   | 3000-6500K                                     |             |             |             |
| Luminous Flux         | 12,000lm                                       | 18,000lm    | 24,000lm    | 36,000lm    |
| Luminous Efficacy     | 120lm/w  |             |             |             |
| CRI                   | ≥ 80Ra   |             |             |             |
| Light Distribution    | 90°  |             |             |             |
| Protection Class      | Class I  |             |             |             |
| Input Voltage         | AC95-265V                                      |             |             |             |
| Frequency             | 50/60HZ  |             |             |             |
| Power Factor          | ≥ 0.6  |             |             |             |
| Lifetime              | 8000H  |             |             |             |
| Surge protection      | 4KV(+10KV optional)                            |             |             |             |
| Material              | Die-cast aluminium + PC lens                   |             |             |             |
| IP                    | IP66   |             |             |             |
| IK                    | IK08   |             |             |             |
| Lamp Size(mm)         | 380x105x30                                     | 430x120x30  | 490x135x30  | 580x150x30  |
| PCS/CTN               | 30   | 30          | 20          | 20          |
| Carton Size(mm)       | 400x230x320                                    | 450x260x320 | 510x290x320 | 600x320x320 |
| Net Weight(kg)        | 0.65   | 0.8         | 1           | 1.35        |
| Gross Weight(kg)      | 21.5   | 26          | 22          | 29          |
| Operating Temperature | -30°C ~50°C                                    |             |             |             |
| Warranty              | 2 Years Warranty                               |             |             |             |

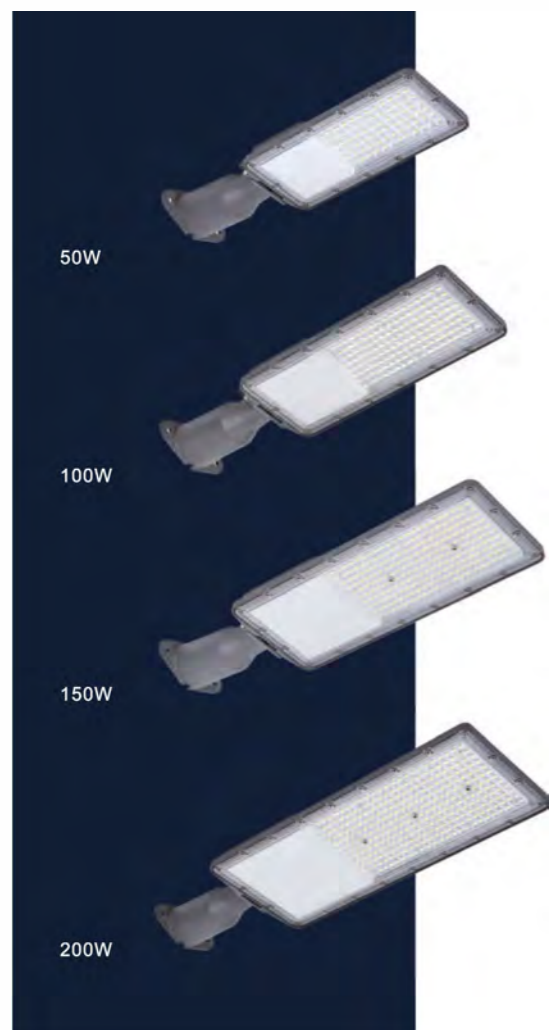

## KEY ADVANTAGES

- Cost-effective and efficient lighting solution
- Die-cast aluminium body for robust construction
- Fin-type design for better heat dissipation
- Four sizes for power 50W-200W, catering for different lighting needs
- IP 65 tightness level, water-proof & dust-proof

## Luminance Intensity Distribution

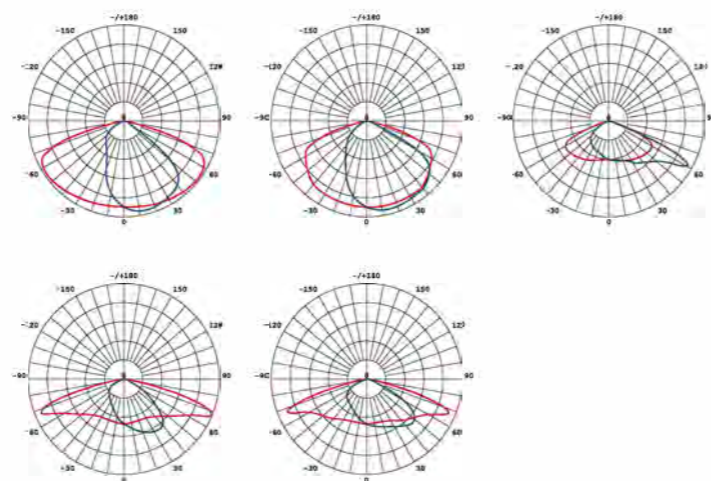

## Dimensions

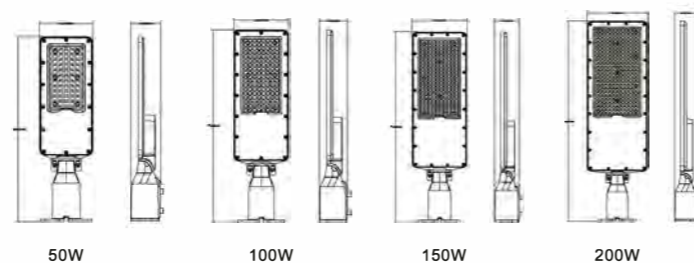

THREE YEARS  
**3**  
WARRANTY  
>100LM/W

## Product Parameter

|                       |  |                  |                  |                  |
|-----------------------|--|------------------|------------------|------------------|
| Model Name            |  |                  |                  |                  |
| Power                 | 50W  | 100W             | 150W             | 200W             |
| Driver Type           | DOB solution                                   |                  |                  |                  |
| Light Source          | BRIGELUX/EPISTAR/SANAN/LUMILEDS/CREE(optional) |                  |                  |                  |
| CCT                   | 2700-6500K                                     |                  |                  |                  |
| Luminous Flux         | 5,000  | 10,000           | 15,000           | 20,000           |
| Luminous Efficacy     | 100lm/w  |                  |                  |                  |
| CRI                   | ≥ 70Ra   |                  |                  |                  |
| Light Distribution    | 65°x135°                                       |                  |                  |                  |
| Protection Class      | Class I  |                  |                  |                  |
| Input Voltage         | AC110-265V                                     |                  |                  |                  |
| Frequency             | 50/60HZ  |                  |                  |                  |
| Power Factor          | > 0.9  |                  |                  |                  |
| Lifetime              | 30000H   |                  |                  |                  |
| Surge protection      | 4KV(+10KV optional)                            |                  |                  |                  |
| Material              | Die-cast Aluminium Body + PC Lens              |                  |                  |                  |
| IP                    | IP65   |                  |                  |                  |
| IK                    | IK08   |                  |                  |                  |
| Lamp Size(mm)         | 460.5X131.4X73.3                               | 520.7X146.4X73.3 | 580.7X166.5X73.3 | 655.7X196.4X73.3 |
| PCS/CTN               | 10   | 10               | 5                | 5                |
| Carton Size(mm)       | 400x280x485                                    | 400x310x545      | 590x400x190      | 670x400x220      |
| Operating Temperature | -25°C ~40°C                                    |                  |                  |                  |
| Warranty              | 3 Years Warranty                               |                  |                  |                  |



### Luminance Intensity Distribution

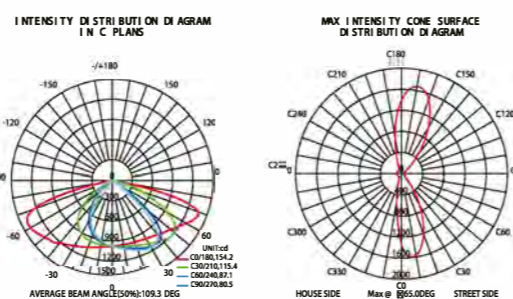

### Dimensions

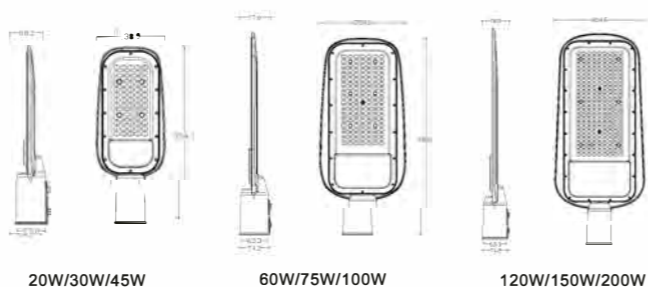

### KEY ADVANTAGES

- Cost effective and efficient lighting solution ( DOB solution)
- Maximised saving in energy and maintenance
- Surge protection 4 to 5KV (+10Kv optional)
- 3 size to offer the most accurate solution
- Wide range of colour temperature
- Wide range of beam angle (optional)
- Housing optimized for heat dissipation and reduce dust accumulation
- IP 65 tightness level

THREE YEARS  
**3**  
WARRANTY  
**>100LM/W**

### Product Parameter

|                              |  |                   |        |        |            |         |         |            |         |  |
|------------------------------|--|-------------------|--------|--------|------------|---------|---------|------------|---------|--|
| <b>Model Name</b>            |  |                   |        |        |            |         |         |            |         |  |
| <b>Power</b>                 | 20W  | 30W               | 45W    | 60W    | 75W        | 100W    | 120W    | 150W       | 200W    |  |
| <b>Light Source</b>          | SANAN/BRIDGELUX/LUMILEDS/CREE(optional)        |                   |        |        |            |         |         |            |         |  |
| <b>CCT</b>                   | 6500K (5000K / 4000K / 3000K available)        |                   |        |        |            |         |         |            |         |  |
| <b>Luminous Flux</b>         | 2000lm   | 3000lm            | 4500lm | 6000lm | 7500lm     | 10000lm | 12000lm | 15000lm    | 20000lm |  |
| <b>Luminous Efficacy</b>     | 100LM/W  |                   |        |        |            |         |         |            |         |  |
| <b>CRI</b>                   | Ra70   |                   |        |        |            |         |         |            |         |  |
| <b>Light Distribution</b>    | Type II  |                   |        |        |            |         |         |            |         |  |
| <b>LED Driver</b>            | DOB solution                                   |                   |        |        |            |         |         |            |         |  |
| <b>Input Voltage</b>         | AC180-265V ( AC80-140V optional)               |                   |        |        |            |         |         |            |         |  |
| <b>Frequency</b>             | 50 / 60 Hz                                     |                   |        |        |            |         |         |            |         |  |
| <b>Power Factor</b>          | ≥0.95 at Max load                              |                   |        |        |            |         |         |            |         |  |
| <b>Power Efficiency</b>      | N/A  |                   |        |        |            |         |         |            |         |  |
| <b>THD</b>                   | <15%   |                   |        |        |            |         |         |            |         |  |
| <b>Surge Protection</b>      | 4 to 5KV (+10Kv optional)                      |                   |        |        |            |         |         |            |         |  |
| <b>Control Method</b>        | N/A  |                   |        |        |            |         |         |            |         |  |
| <b>Adapt to light pole</b>   | 20~45W( φ32、φ42、φ48) 60~200W( φ32、φ42、φ48、φ60) |                   |        |        |            |         |         |            |         |  |
| <b>Size</b>                  | mm   | 355X139X68        |        |        | 489X208X78 |         |         | 599X255X78 |         |  |
| <b>Weight</b>                | kg   | 0.52kg            |        |        | 1.02kg     |         |         | 1.55kg     |         |  |
| <b>Material</b>              | Body   | Die Cast Aluminum |        |        |            |         |         |            |         |  |
|                              | Optic & Cover                                  | PC                |        |        |            |         |         |            |         |  |
| <b>Finish</b>                | Powder Coating                                 |                   |        |        |            |         |         |            |         |  |
| <b>IP Rating</b>             | IP65   |                   |        |        |            |         |         |            |         |  |
| <b>IK Rating</b>             | IK08   |                   |        |        |            |         |         |            |         |  |
| <b>Operating Temperature</b> | -35°C ~ 55°C                                   |                   |        |        |            |         |         |            |         |  |
| <b>Warranty</b>              | 3 Years  |                   |        |        |            |         |         |            |         |  |



### Luminance Intensity Distribution

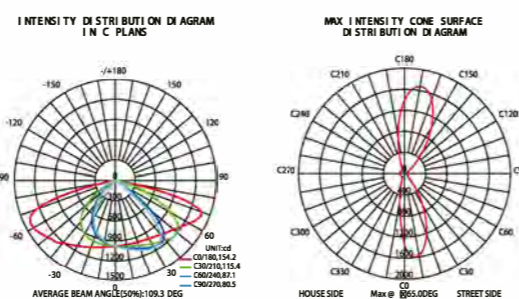

### Dimensions

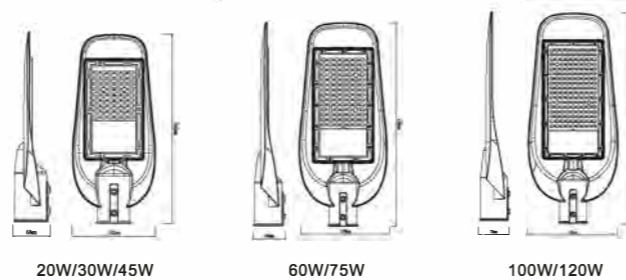

### KEY ADVANTAGES

- Cost effective and efficient lighting solution ( DOB solution)
- Maximised saving in energy and maintenance
- Surge protection 4 to 5KV (+10Kv optional)
- 3 size to offer the most accurate solution
- Wide range of colour temperature
- Wide range of beam angle (optional)
- Housing optimized for heat dissipation and reduce dust accumulation
- IP 65 tightness level

THREE YEARS  
**3**  
WARRANTY  
>100LM/W

### Product Parameter

|                       |  |                |        |            |        |            |         |
|-----------------------|--|----------------|--------|------------|--------|------------|---------|
| <b>Model Name</b>     |  |                |        |            |        |            |         |
| Power                 | 20W  | 30W            | 45W    | 60W        | 75W    | 100W       | 120W    |
| Light Source          | SANAN/BRIDGELUX/LUMILEDS/CREE(optional)          |                |        |            |        |            |         |
| CCT                   | 6500K (5000K / 4000K / 3000K available)          |                |        |            |        |            |         |
| Luminous Flux         | 2000lm   | 3000lm         | 4500lm | 6000lm     | 7500lm | 10000lm    | 12000lm |
| Luminous Efficacy     | 100LM/W  |                |        |            |        |            |         |
| CRI                   | Ra80   |                |        |            |        |            |         |
| Light Distribution    | Type II (design according project requirement)   |                |        |            |        |            |         |
| LED Driver            | DOB solution                                     |                |        |            |        |            |         |
| Input Voltage         | AC180-265V ( AC80-140V optional)                 |                |        |            |        |            |         |
| Frequency             | 50 / 60 Hz                                       |                |        |            |        |            |         |
| Power Factor          | ≥0.95 at Max load                                |                |        |            |        |            |         |
| Power Efficiency      | N/A  |                |        |            |        |            |         |
| THD                   | <15%   |                |        |            |        |            |         |
| Surge Protection      | 4 to 5KV (+10Kv optional)                        |                |        |            |        |            |         |
| Control Method        | N/A  |                |        |            |        |            |         |
| Adapt to light pole   | 20~75W( φ32、φ42、φ48 ) 100~120W( φ32、φ42、φ48、φ60) |                |        |            |        |            |         |
| Size                  | mm   | 346X152X68     |        | 436X190X68 |        | 534X230X78 |         |
| Weight                | kg   | 0.72kg         |        | 1.08kg     |        | 1.51kg     |         |
| Material              | Body   | ADC12 Aluminum |        |            |        |            |         |
|                       | Optic & Cover                                    | PC             |        |            |        |            |         |
| Finish                | Powder Coating                                   |                |        |            |        |            |         |
| IP Rating             | IP65   |                |        |            |        |            |         |
| IK Rating             | IK09   |                |        |            |        |            |         |
| Operating Temperature | -35°C ~ 55°C                                     |                |        |            |        |            |         |
| Warranty              | 3 Years  |                |        |            |        |            |         |

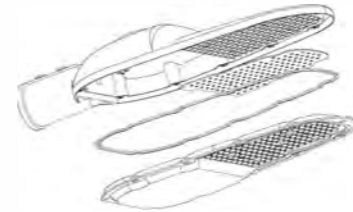
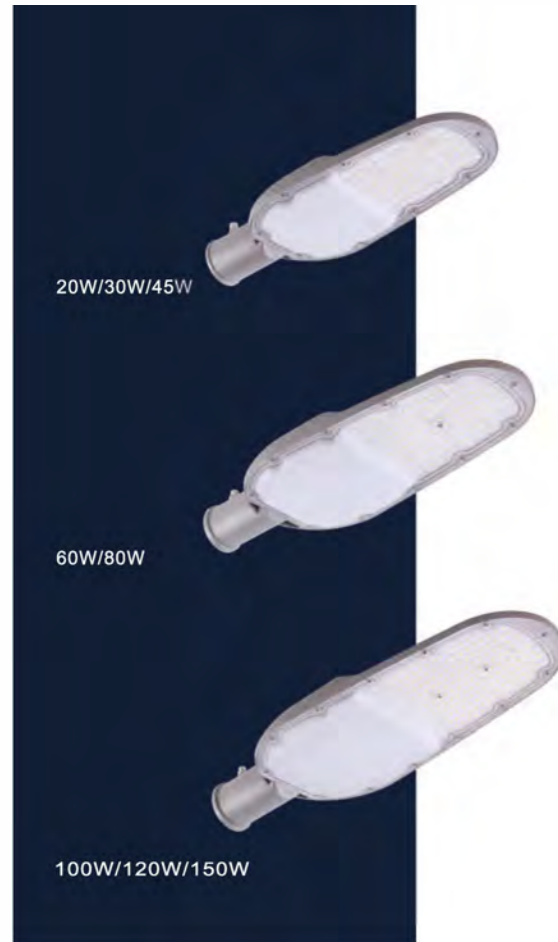

### Luminance Intensity Distribution

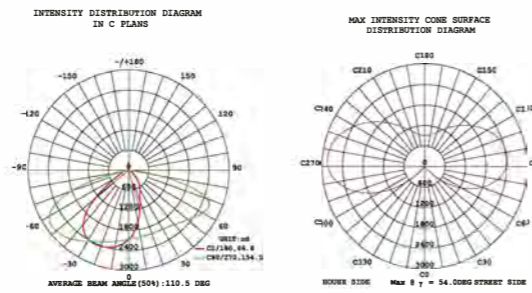

### Dimensions

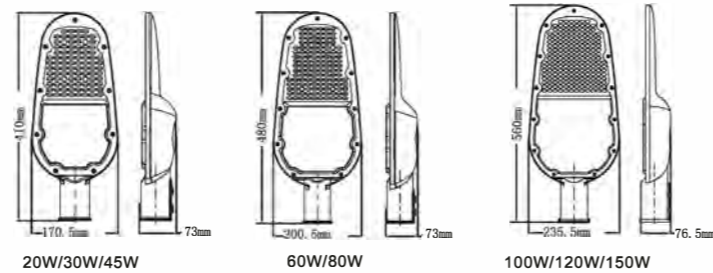

## KEY ADVANTAGES

- Cost effective and efficient lighting solution
- 3 size to offer the most accurate solution
- Wide range of colour temperature
- Wide range of operating temperature
- Side-entry mounting for pole  $\Phi 32$  to  $60\text{mm}$  / 1" to 2"
- Ready for Smart city connectivity with NEMA socket
- Surge protection 4 to 6KV (+10Kv optional)
- Housing optimized for heat dissipation
- IP 66 tightness level

**FIVE YEARS**  
**5**  
**WARRANTY**  
**>150LM/W**

### Product Parameter

|                              |   |                |        |        |            |         |            |         |
|------------------------------|---|----------------|--------|--------|------------|---------|------------|---------|
| <b>Model Name</b>            |   |                |        |        |            |         |            |         |
| <b>Power</b>                 | 20W   | 30W            | 45W    | 60W    | 80W        | 100W    | 120W       | 150W    |
| <b>Light Source</b>          | SANAN/BRIDGELUX/LUMILEDS/CREE(optional)   |                |        |        |            |         |            |         |
| <b>CCT</b>                   | 6500K (5000K / 4000K / 3000K available)   |                |        |        |            |         |            |         |
| <b>Luminous Flux</b>         | 3000lm  | 4500lm         | 6750lm | 9000lm | 12000lm    | 15000lm | 18000lm    | 22500lm |
| <b>Luminous Efficacy</b>     | 130LM/W   |                |        |        | 150LM/W    |         |            |         |
| <b>CRI</b>                   | Ra70  |                |        |        |            |         |            |         |
| <b>Light Distribution</b>    | Type II (design according project requirement)  |                |        |        |            |         |            |         |
| <b>LED Driver</b>            | AC90-305V   |                |        |        |            |         |            |         |
| <b>Input Voltage</b>         | 50 / 60 Hz  |                |        |        |            |         |            |         |
| <b>Frequency</b>             | $\geq 0.9$ at Max load  |                |        |        |            |         |            |         |
| <b>Power Factor</b>          | 0.93  |                |        |        |            |         |            |         |
| <b>Power Efficiency</b>      | <15%  |                |        |        |            |         |            |         |
| <b>THD</b>                   | 4 to 6KV (+10Kv optional)   |                |        |        |            |         |            |         |
| <b>Surge Protection</b>      | 0-10V / PWM / TIME CONTROL / DALI   |                |        |        |            |         |            |         |
| <b>Control Method</b>        |   |                |        |        |            |         |            |         |
| <b>Adapt to light pole</b>   | 20~80W( $\phi 32$ 、 $\phi 42$ 、 $\phi 48$ ) 100~150W( $\phi 32$ 、 $\phi 42$ 、 $\phi 48$ 、 $\phi 60$ ) |                |        |        |            |         |            |         |
| <b>Size</b>                  | mm  | 410x171x73     |        |        | 480x201x73 |         | 560x236x77 |         |
| <b>Weight</b>                | kg  | 1.495kg        |        |        | 2.21kg     |         | 2.685kg    |         |
| <b>Material</b>              | Body  | ADC12 Aluminum |        |        |            |         |            |         |
|                              | Optic & Cover   | PC             |        |        |            |         |            |         |
| <b>Finish</b>                | Powder Coating  |                |        |        |            |         |            |         |
| <b>IP Rating</b>             | IP66  |                |        |        |            |         |            |         |
| <b>IK Rating</b>             | IK09  |                |        |        |            |         |            |         |
| <b>Operating Temperature</b> | $-35^{\circ}\text{C} \sim 55^{\circ}\text{C}$   |                |        |        |            |         |            |         |
| <b>Warranty</b>              | 3/5/7Years  |                |        |        |            |         |            |         |



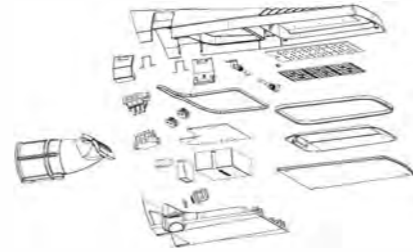

### Luminance Intensity Distribution

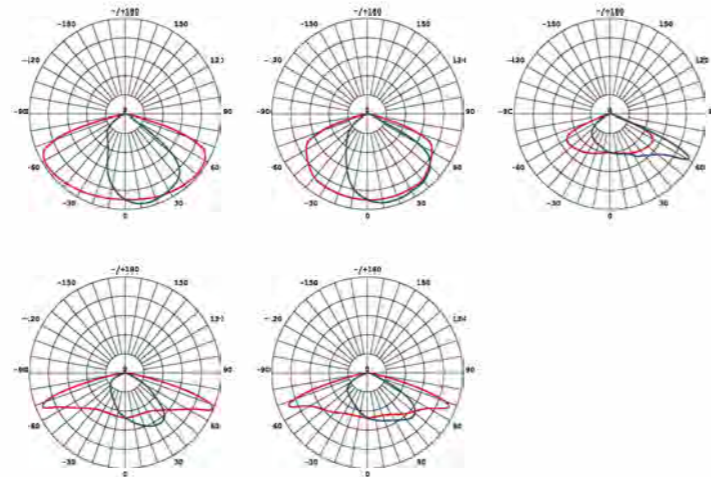

### KEY ADVANTAGES

- Fin-type lamp surface to better facilitate heat dissipation
- Tool-less access to lamp compartment for easy maintenance & replacement
- Angle adjustable for flexible mounting: side-entry & post-top
- High luminous efficiency achievable up to 170±5%lm/w

### Dimensions

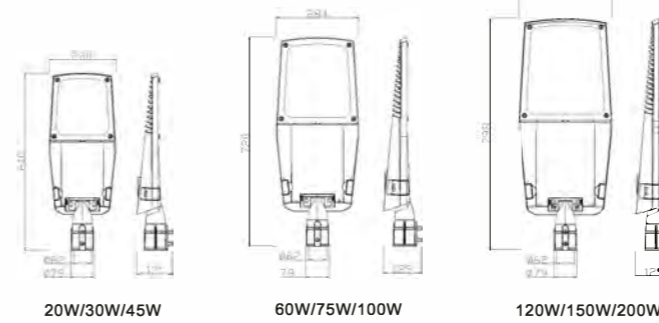

### Product Parameter

|                       | 30W  | 45W     | 60W     | 80W         | 100W     | 120W     | 150W        | 200W     |
|-----------------------|--|---------|---------|-------------|----------|----------|-------------|----------|
| Power                 | 30W  | 45W     | 60W     | 80W         | 100W     | 120W     | 150W        | 200W     |
| Driver Type           |  |         |         |             |          |          |             |          |
| Light Source          | BRIGELUX/EPISTAR/SANAN/LUMILEDS/CREE(optional)                 |         |         |             |          |          |             |          |
| CCT                   | 2700-6500K   |         |         |             |          |          |             |          |
| Luminous Flux         | 4,800lm  | 7,200lm | 9,600lm | 12,800lm    | 16,000lm | 19,200lm | 24,000lm    | 32,000lm |
| Luminous Efficacy     | 160lm/w  |         |         |             |          |          |             |          |
| CRI                   | ≥ 70Ra   |         |         |             |          |          |             |          |
| Light Distribution    | TYPE II, TYPE II-B, TYPE III, TYPE IV-B, SCL, XW(upon request) |         |         |             |          |          |             |          |
| Protection Class      | Class I  |         |         |             |          |          |             |          |
| Input Voltage         | AC90-305V  |         |         |             |          |          |             |          |
| Frequency             | 50/60HZ  |         |         |             |          |          |             |          |
| Power Factor          | 0.95   |         |         |             |          |          |             |          |
| Lifetime              | 50000H   |         |         |             |          |          |             |          |
| Surge protection      | 4 to 6KV(+10KV optional)                                       |         |         |             |          |          |             |          |
| Material              | Die-cast Aluminium Body + PC Lens                              |         |         |             |          |          |             |          |
| IP                    | IP66   |         |         |             |          |          |             |          |
| IK                    | IK08   |         |         |             |          |          |             |          |
| Lamp Size(mm)         | 610x230x121  |         |         | 720x284x129 |          |          | 798x320x129 |          |
| Operating Temperature | -40°C ~50°C  |         |         |             |          |          |             |          |
| Warranty              | 5/7 Years Warranty   |         |         |             |          |          |             |          |

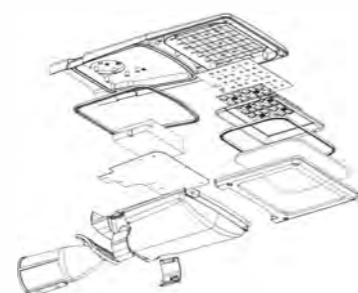

### Luminance Intensity Distribution

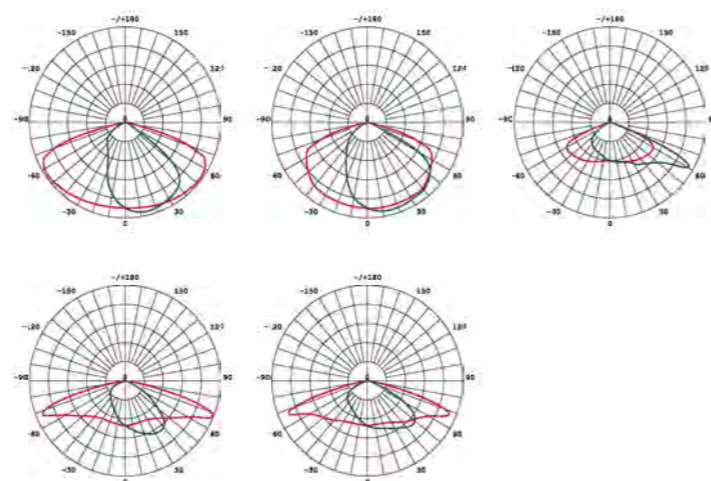

### KEY ADVANTAGES

- Efficient lighting solution
- Wide range of colour temperature
- Housing optimized for heat dissipation and reduce dust accumulation
- Wide range of beam angle (optional)
- Surge protection 4 to 6KV (+10Kv optional)
- Side-entry mounting for pole  $\Phi 32$  to 60mm / 1" to 2"
- Ready for Smart city connectivity with NEMA socket
- 3 size to offer the most accurate solution
- Can be inclined from 0 to +15 degree
- Wide range of operating temperature
- Tool Free maintenance
- IP 66 tightness level

### Dimensions



SEVEN YEARS  
**7**  
WARRANTY  
>140LM/W

### Product Parameter

|                              |  |                |        |         |              |         |         |             |       |  |
|------------------------------|--|----------------|--------|---------|--------------|---------|---------|-------------|-------|--|
| <b>Model Name</b>            |  |                |        |         |              |         |         |             |       |  |
| <b>Power</b>                 | 30W  | 45W            | 60W    | 80W     | 100W         | 120W    | 150W    | 200W        |       |  |
| <b>Light Source</b>          | SANAN/BRIDGELUX/LUMILEDS/CREE(optional)  |                |        |         |              |         |         |             |       |  |
| <b>CCT</b>                   | 6500K (5000K / 4000K / 3000K available)  |                |        |         |              |         |         |             |       |  |
| <b>Luminous Flux</b>         | 4200lm   | 6300lm         | 8400lm | 11200lm | 14000lm      | 16800lm | 21000lm | 28000lm     |       |  |
| <b>Luminous Efficacy</b>     | 140LM/W  |                |        |         |              |         |         |             |       |  |
| <b>CRI</b>                   | Ra70   |                |        |         |              |         |         |             |       |  |
| <b>Light Distribution</b>    | Type II, Type II-B, Type III, Type IV-B, SCL, XW (design according project requirement)                            |                |        |         |              |         |         |             |       |  |
| <b>LED Driver</b>            |  |                |        |         |              |         |         |             |       |  |
| <b>Input Voltage</b>         | AC90-305V  |                |        |         |              |         |         |             |       |  |
| <b>Frequency</b>             | 50 / 60 Hz   |                |        |         |              |         |         |             |       |  |
| <b>Power Factor</b>          | $\geq 0.95$  |                |        |         |              |         |         |             |       |  |
| <b>Power Efficiency</b>      | 0.93   |                |        |         |              |         |         |             |       |  |
| <b>THD</b>                   | <15%   |                |        |         |              |         |         |             |       |  |
| <b>Surge Protection</b>      | 4 to 6KV (+10Kv optional)  |                |        |         |              |         |         |             |       |  |
| <b>Control Method</b>        | 0-10V / PWM / TIME CONTROL / DALI  |                |        |         |              |         |         |             |       |  |
| <b>Adapt to light pole</b>   | 30~120W( $\Phi 32$ 、 $\Phi 42$ 、 $\Phi 48$ 、 $\Phi 60$ ) 150~200W( $\Phi 32$ 、 $\Phi 42$ 、 $\Phi 48$ 、 $\Phi 60$ ) |                |        |         |              |         |         |             |       |  |
| <b>Size</b>                  | mm   | 567x235x92.6   |        |         | 669x279x94.6 |         |         | 752x308x116 |       |  |
| <b>Weight</b>                | kg   | 3.6kg          | 3.6kg  | 3.6kg   | 5.8kg        | 5.8kg   | 5.8kg   | 7.9kg       | 7.9kg |  |
| <b>Material</b>              | Body   | ADC12 Aluminum |        |         |              |         |         |             |       |  |
|                              | Optic  | PC             |        |         |              |         |         |             |       |  |
|                              | Cover  | Tempered Glass |        |         |              |         |         |             |       |  |
| <b>Finish</b>                | Powder Coating   |                |        |         |              |         |         |             |       |  |
| <b>IP Rating</b>             | IP66   |                |        |         |              |         |         |             |       |  |
| <b>IK Rating</b>             | IK08   |                |        |         |              |         |         |             |       |  |
| <b>Operating Temperature</b> | $-40^{\circ}\text{C} \sim 50^{\circ}\text{C}$  |                |        |         |              |         |         |             |       |  |
| <b>Warranty</b>              | 5/7 Years  |                |        |         |              |         |         |             |       |  |

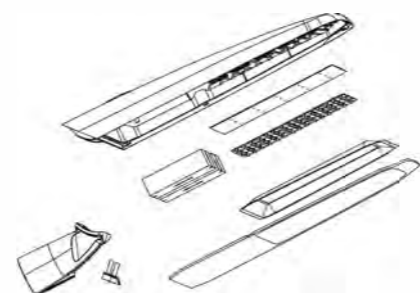
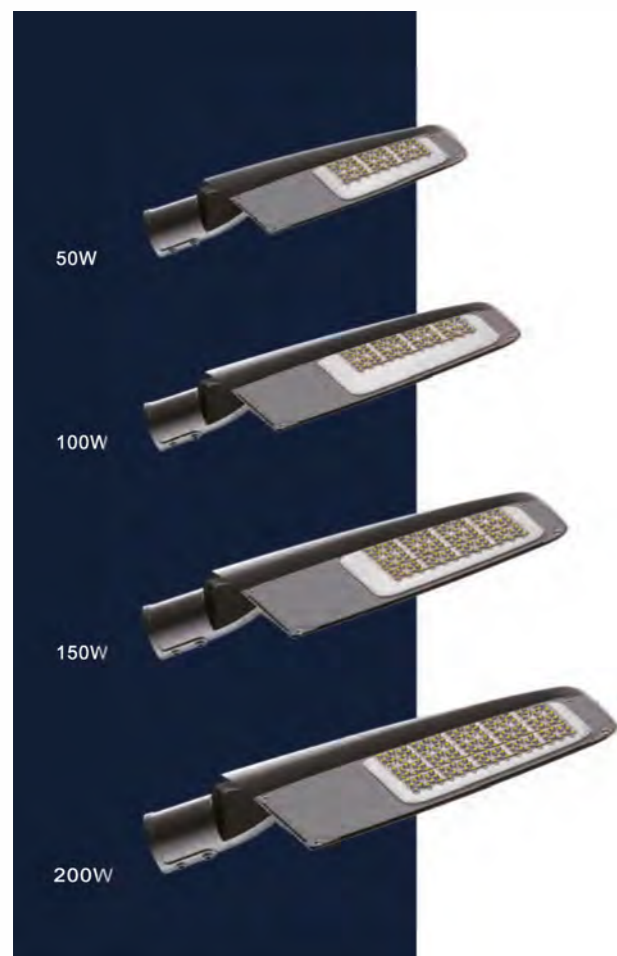

### Luminance Intensity Distribution

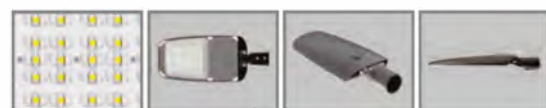
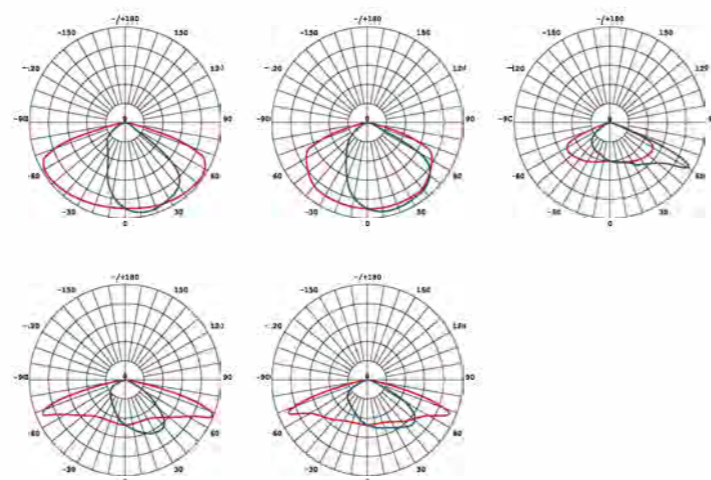

### KEY ADVANTAGES

- Die-cast aluminium body for robust construction
- Streamline & smooth surface to prevent dust & dirt accumulation
- Wide range of beam angle options
- Ready for smart city connectivity with NEMA socket
- Housing optimized for heat dissipation
- IP 65 tightness level, water-proof & dust-proof

### Dimensions

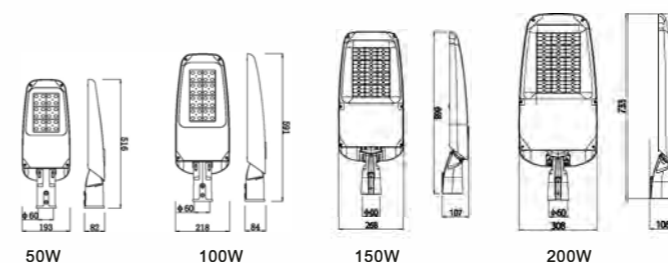

### Product Parameter

|                       |   |             |             |             |
|-----------------------|---|-------------|-------------|-------------|
| Model Name            |   |             |             |             |
| Power                 | 50W   | 100W        | 150W        | 200W        |
| Driver Type           |   |             |             |             |
| Light Source          | BRIGELUX/EPISTAR/SANAN/LUMILEDS/CREE(optional)                |             |             |             |
| CCT                   | 3000-6000K  |             |             |             |
| Luminous Flux         | 7,000lm   | 14,000lm    | 21,000lm    | 28,000lm    |
| Luminous Efficacy     | 140lm/w   |             |             |             |
| CRI                   | ≥ 70Ra  |             |             |             |
| Light Distribution    | TYPE II(TYPE II-B, TYPE III, TYPE IV-B, SCL, XW upon request) |             |             |             |
| Protection Class      | Class I   |             |             |             |
| Input Voltage         | AC100-277V  |             |             |             |
| Frequency             | 50/60HZ   |             |             |             |
| Power Factor          | ≥ 0.95  |             |             |             |
| Lifetime              | 50000H  |             |             |             |
| Surge protection      | 4-6KV(+10KV optional)   |             |             |             |
| Material              | Die-cast Aluminium Body + PC Lens+ Tempered Glass             |             |             |             |
| IP                    | IP65  |             |             |             |
| IK                    | IK08  |             |             |             |
| Lamp Size(mm)         | 516x193x82  | 591x218x84  | 668x268x107 | 733x307x106 |
| PCS/CTN               | 1   | 1           | 1           | 1           |
| Carton Size(mm)       | 530x210x110   | 610x230x110 | 720x310x180 | 790x340x185 |
| Net Weight(kg)        | 2.5   | 4           | 5.85        | 5.85        |
| Gross Weight(kg)      | 3   | 4.5         | 6.5         | 6.5         |
| Operating Temperature | -25°C~40°C  |             |             |             |
| Warranty              | 5/7 Years Warranty  |             |             |             |

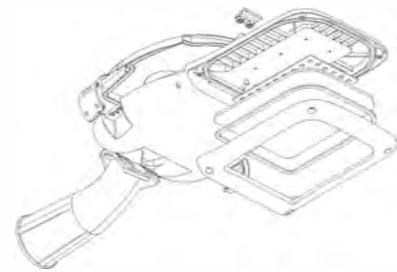

### Luminance Intensity Distribution

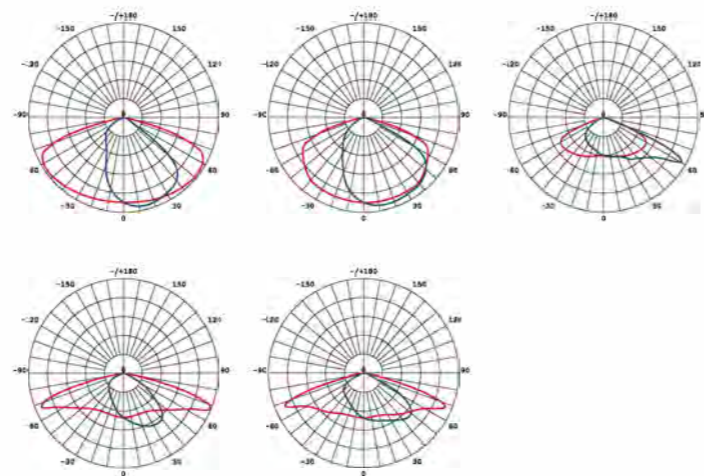

### KEY ADVANTAGES

- Efficient lighting solution
- Wide range of colour temperature
- Housing optimized for heat dissipation and reduce dust accumulation
- Wide range of beam angle (optional)
- Surge protection 4 to 6KV (+10Kv optional)
- Side-entry mounting for pole  $\Phi 32$  to 60mm / 1" to 2"
- Ready for Smart city connectivity with NEMA socket
- 3 size to offer the most accurate solution
- Can be inclined from 0 to +15 degree
- Wide range of operating temperature
- Tool Free maintenance
- IP 66 tightness level

### Dimensions

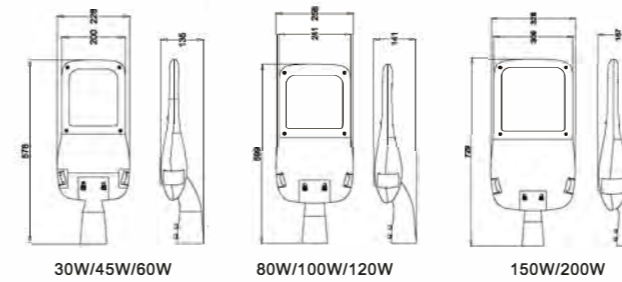

SEVEN YEARS  
**7**  
WARRANTY  
>140LM/W

### Product Parameter

|                              |  |                |        |         |             |         |         |             |       |  |
|------------------------------|--|----------------|--------|---------|-------------|---------|---------|-------------|-------|--|
| <b>Model Name</b>            |  |                |        |         |             |         |         |             |       |  |
| <b>Power</b>                 | 30W  | 45W            | 60W    | 80W     | 100W        | 120W    | 150W    | 200W        |       |  |
| <b>Light Source</b>          | SANAN/BRIDGELUX/LUMILEDS/CREE(optional)  |                |        |         |             |         |         |             |       |  |
| <b>CCT</b>                   | 6500K (5000K / 4000K / 3000K available)  |                |        |         |             |         |         |             |       |  |
| <b>Luminous Flux</b>         | 4200lm   | 6300lm         | 8400lm | 11200lm | 14000lm     | 16800lm | 21000lm | 28000lm     |       |  |
| <b>Luminous Efficacy</b>     | 140LM/W  |                |        |         |             |         |         |             |       |  |
| <b>CRI</b>                   | Ra70   |                |        |         |             |         |         |             |       |  |
| <b>Light Distribution</b>    | Type II, Type II-B, Type III, Type IV-B, SCL, XW (design according project requirement)  |                |        |         |             |         |         |             |       |  |
| <b>LED Driver</b>            |  |                |        |         |             |         |         |             |       |  |
| <b>Input Voltage</b>         | 50 / 60 Hz   |                |        |         |             |         |         |             |       |  |
| <b>Frequency</b>             | $\geq 0.95$  |                |        |         |             |         |         |             |       |  |
| <b>Power Factor</b>          | 0.93   |                |        |         |             |         |         |             |       |  |
| <b>Power Efficiency</b>      | <15%   |                |        |         |             |         |         |             |       |  |
| <b>THD</b>                   | 4 to 6KV (+10Kv optional)  |                |        |         |             |         |         |             |       |  |
| <b>Surge Protection</b>      | 0-10V / PWM / TIME CONTROL / DALI  |                |        |         |             |         |         |             |       |  |
| <b>Control Method</b>        | 30~120W( $\phi 32$ 、 $\phi 42$ 、 $\phi 48$ 、 $\phi 60$ ) 150~200W( $\phi 32$ 、 $\phi 42$ 、 $\phi 48$ 、 $\phi 60$ 、 $\phi 76$ ) |                |        |         |             |         |         |             |       |  |
| <b>Adapt to light pole</b>   |  |                |        |         |             |         |         |             |       |  |
| <b>Size</b>                  | mm   | 578X228X135    |        |         | 599X256X141 |         |         | 729X328X157 |       |  |
| <b>Weight</b>                | kg   | 3.2kg          | 3.2kg  | 3.2kg   | 4.2kg       | 4.2kg   | 4.2kg   | 7.2kg       | 7.2kg |  |
| <b>Material</b>              | Body   | ADC12 Aluminum |        |         |             |         |         |             |       |  |
|                              | Optic  | PC             |        |         |             |         |         |             |       |  |
|                              | Cover  | Tempered Glass |        |         |             |         |         |             |       |  |
| <b>Finish</b>                | Powder Coating   |                |        |         |             |         |         |             |       |  |
| <b>IP Rating</b>             | IP66   |                |        |         |             |         |         |             |       |  |
| <b>IK Rating</b>             | IK08   |                |        |         |             |         |         |             |       |  |
| <b>Operating Temperature</b> | -40°C ~ 50°C   |                |        |         |             |         |         |             |       |  |
| <b>Warranty</b>              | 5/7 Years  |                |        |         |             |         |         |             |       |  |



30W/45W/60W/80W

105W/120W/150W/180W

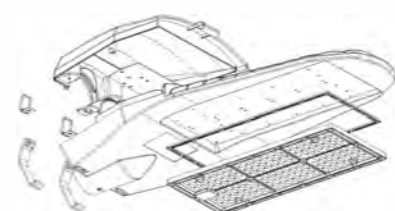

### Luminance Intensity Distribution

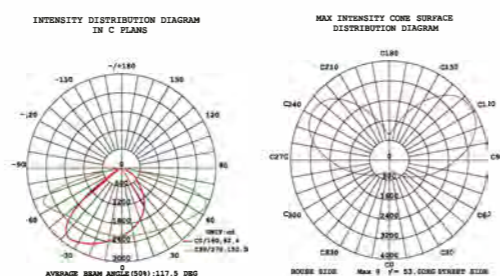

### Dimensions

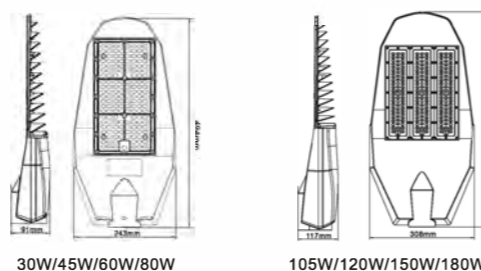

## KEY ADVANTAGES

- Efficient lighting solution
- Wide range of colour temperature
- Housing optimized for heat dissipation
- Wide range of beam angle (optional)
- Surge protection 4 to 6KV (+10Kv optional)
- Side-entry mounting for pole  $\Phi 32$  to 60mm / 1" to 2"
- Superior efficacy : from 130 to 140 Lm/W depending on the model
- Wide range of operating temperature
- Tool Free maintenance
- IP 66 tightness level



### Product Parameter

|                              |   |                |        |         |         |             |         |         |        |  |
|------------------------------|---|----------------|--------|---------|---------|-------------|---------|---------|--------|--|
| <b>Model Name</b>            |   |                |        |         |         |             |         |         |        |  |
| <b>Power</b>                 | 30W   | 45W            | 60W    | 80W     | 105W    | 120W        | 150W    | 180W    |        |  |
| <b>Light Source</b>          | SANAN/BRIDGELUX/LUMILEDS/CREE(optional)   |                |        |         |         |             |         |         |        |  |
| <b>CCT</b>                   | 6500K (5000K / 4000K / 3000K available)   |                |        |         |         |             |         |         |        |  |
| <b>Luminous Flux</b>         | 4200lm  | 6300lm         | 8400lm | 11200lm | 14700lm | 16800lm     | 19500lm | 23400lm |        |  |
| <b>Luminous Efficacy</b>     | 140LM/W   |                |        |         |         |             |         |         |        |  |
| <b>CRI</b>                   | Ra70  |                |        |         |         |             |         |         |        |  |
| <b>Light Distribution</b>    | Type II (design according project requirement)  |                |        |         |         |             |         |         |        |  |
| <b>LED Driver</b>            | AC90-305V   |                |        |         |         |             |         |         |        |  |
| <b>Input Voltage</b>         | 50 / 60 Hz  |                |        |         |         |             |         |         |        |  |
| <b>Frequency</b>             | $\geq 0.95$   |                |        |         |         |             |         |         |        |  |
| <b>Power Factor</b>          | 0.93  |                |        |         |         |             |         |         |        |  |
| <b>Power Efficiency</b>      | <15%  |                |        |         |         |             |         |         |        |  |
| <b>THD</b>                   | 4 to 6KV (+10Kv optional)   |                |        |         |         |             |         |         |        |  |
| <b>Surge Protection</b>      | 0-10V / PWM / TIME CONTROL / DALI   |                |        |         |         |             |         |         |        |  |
| <b>Control Method</b>        |   |                |        |         |         |             |         |         |        |  |
| <b>Adapt to light pole</b>   | 30~80W( $\phi 32$ 、 $\phi 42$ 、 $\phi 48$ 、 $\phi 60$ ) 105~180W( $\phi 32$ 、 $\phi 42$ 、 $\phi 48$ 、 $\phi 60$ ) |                |        |         |         |             |         |         |        |  |
| <b>Size</b>                  | mm  | 494X243X91     |        |         |         | 635X308X117 |         |         |        |  |
| <b>Weight</b>                | kg  | 3.10KG         | 3.25KG | 3.26KG  | 3.3KG   | 5.92KG      | 5.94KG  | 6.21KG  | 6.22KG |  |
| <b>Material</b>              | Body  | ADC12 Aluminum |        |         |         |             |         |         |        |  |
|                              | Optic & Cover   | PC             |        |         |         |             |         |         |        |  |
| <b>Finish</b>                | Powder Coating  |                |        |         |         |             |         |         |        |  |
| <b>IP Rating</b>             | IP66  |                |        |         |         |             |         |         |        |  |
| <b>IK Rating</b>             | IK09  |                |        |         |         |             |         |         |        |  |
| <b>Operating Temperature</b> | $-40^{\circ}\text{C} \sim 50^{\circ}\text{C}$   |                |        |         |         |             |         |         |        |  |
| <b>Warranty</b>              | 5/7 Years   |                |        |         |         |             |         |         |        |  |

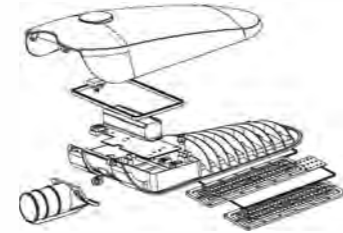

### Luminance Intensity Distribution

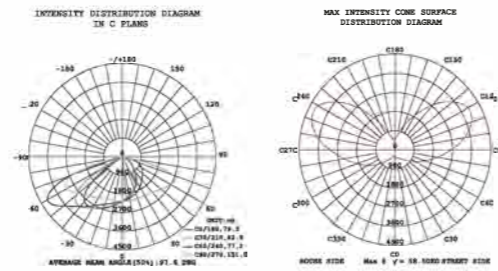

### Dimensions

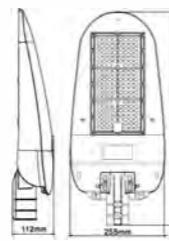

30W/45W/60W/80W

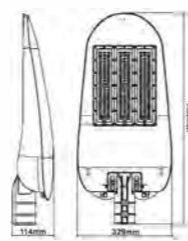

105W/120W/150W/180W



### KEY ADVANTAGES

- Efficient lighting solution
- Wide range of colour temperature
- Wide range of beam angle (optional)
- Surge protection 4 to 6KV (+10Kv optional)
- Side-entry mounting for pole  $\Phi 32$  to 60mm / 1" to 2"
- Superior efficacy : from 130 to 140 Lm/W depending on the model
- Ready for Smart city connectivity with NEMA socket
- Smooth housing optimized for reduce dust accumulation
- Universal fixation with adjustable inclination in steps of 4 degree from 0 to 12
- Wide range of operating temperature
- IP 66 tightness level

SEVEN YEARS  
**7**  
WARRANTY  
>140LM/W

### Product Parameter

|                       | 30W   | 45W            | 60W    | 80W     | 105W    | 120W        | 150W    | 180W    |        |
|-----------------------|---|----------------|--------|---------|---------|-------------|---------|---------|--------|
| Power                 | 30W   | 45W            | 60W    | 80W     | 105W    | 120W        | 150W    | 180W    |        |
| Light Source          | SANAN/BRIDGELUX/LUMILEDS/CREE(optional)   |                |        |         |         |             |         |         |        |
| CCT                   | 6500K (5000K / 4000K / 3000K available)   |                |        |         |         |             |         |         |        |
| Luminous Flux         | 4200lm  | 6300lm         | 8400lm | 11200lm | 14700lm | 16800lm     | 19500lm | 23400lm |        |
| Luminous Efficacy     | 140LM/W   |                |        |         |         |             |         |         |        |
| CRI                   | $\geq$ Ra70   |                |        |         |         |             |         |         |        |
| Light Distribution    | Type II (design according project requirement)  |                |        |         |         |             |         |         |        |
| LED Driver            |   |                |        |         |         |             |         |         |        |
| Input Voltage         | 50 / 60 Hz  |                |        |         |         |             |         |         |        |
| Frequency             | $\geq$ 0.95   |                |        |         |         |             |         |         |        |
| Power Factor          | 0.93  |                |        |         |         |             |         |         |        |
| Power Efficiency      | <15%  |                |        |         |         |             |         |         |        |
| THD                   | 4 to 6KV (+10Kv optional)   |                |        |         |         |             |         |         |        |
| Surge Protection      | 0-10V / PWM / TIME CONTROL / DALI   |                |        |         |         |             |         |         |        |
| Control Method        |   |                |        |         |         |             |         |         |        |
| Adapt to light pole   | 30~80W( $\Phi 32$ 、 $\Phi 42$ 、 $\Phi 48$ ) 105~180W( $\Phi 32$ 、 $\Phi 42$ 、 $\Phi 48$ 、 $\Phi 60$ ) |                |        |         |         |             |         |         |        |
| Size                  | mm  | 572X255X112    |        |         |         | 734X329X114 |         |         |        |
| Weight                | kg  | 3.48KG         | 3.63KG | 3.64KG  | 3.68KG  | 6.74KG      | 6.76KG  | 7.03KG  | 7.04KG |
| Material              | Body  | ADC12 Aluminum |        |         |         |             |         |         |        |
|                       | Optic & Cover   | PC             |        |         |         |             |         |         |        |
| Finish                | Powder Coating  |                |        |         |         |             |         |         |        |
| IP Rating             | IP66  |                |        |         |         |             |         |         |        |
| IK Rating             | IK09  |                |        |         |         |             |         |         |        |
| Operating Temperature | -40°C ~ 50°C  |                |        |         |         |             |         |         |        |
| Warranty              | 5/7 Years   |                |        |         |         |             |         |         |        |

# LED SOLAR LIGHT



## APPLICATIONS



## PRODUCT FEATURES

- Perfect replacement for traditional lights.
- 100% green energy save 100% electricity cost
- Dedicated Ip65 sealed optical cavities.
- Optically optimized lenses.
- Uniformity in light distribution-maximizes efficiency.
- Fully operational in extreme weather up  $-35^{\circ}\text{C}$  to  $+55^{\circ}\text{C}$ .
- Low maintenance & Low power consumption.

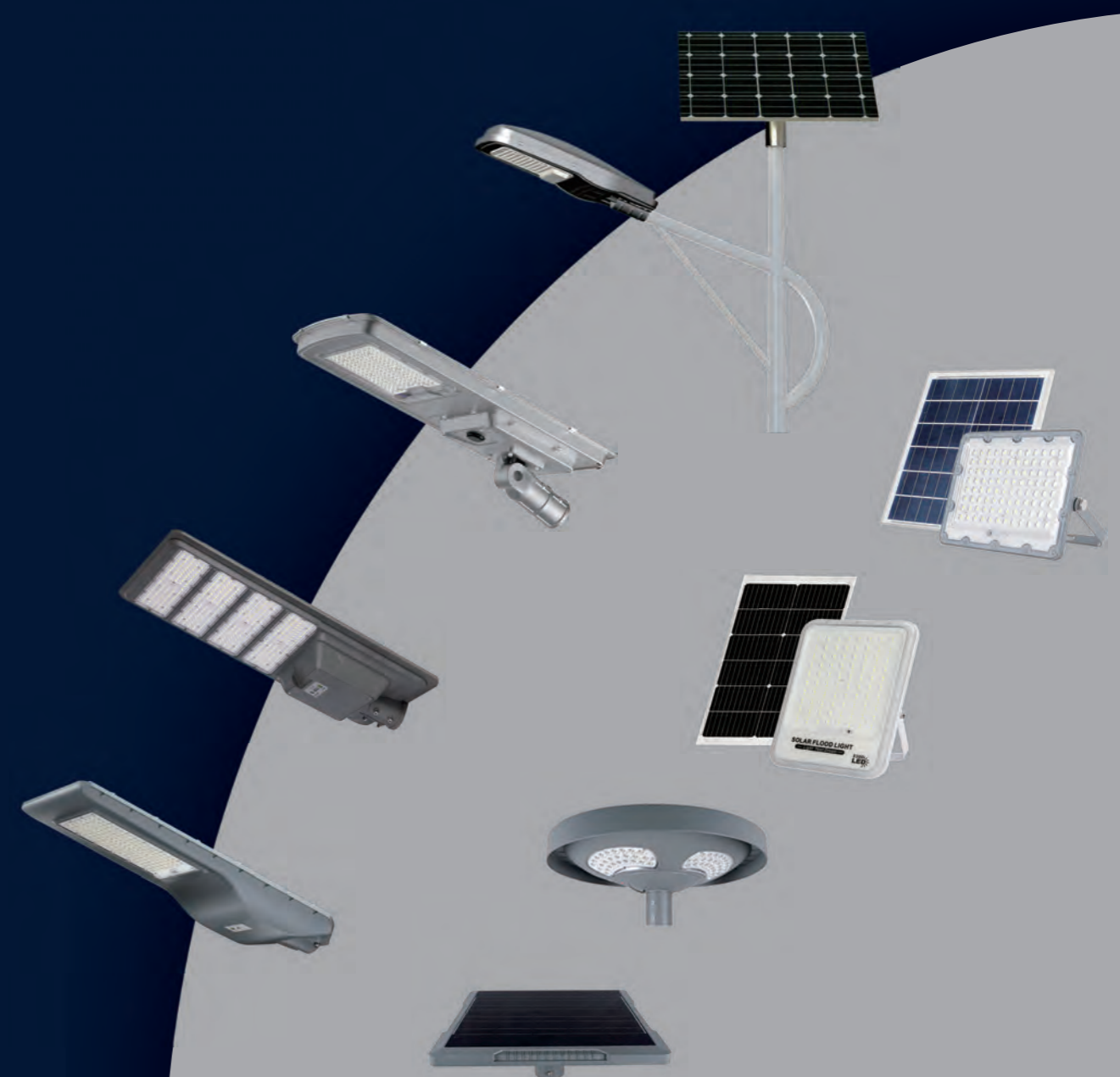



### Dimensions

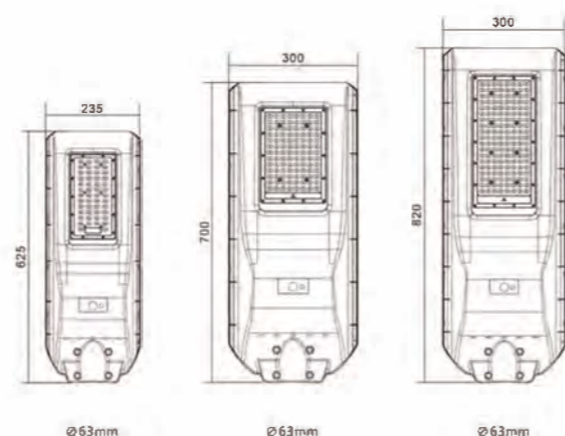

### KEY ADVANTAGES

- Cost effective and efficient lighting solution
- Green lighting solution powered by solar energy
- Integral design with high-transmittance optical lens
- No need for wiring, ready to use
- IP 66 tightness level, water-proof & dust-proof

### Luminance Intensity Distribution

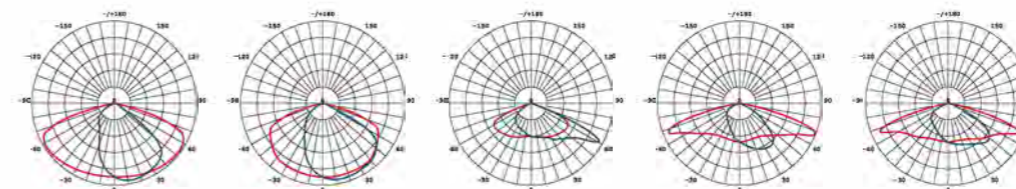

TWO YEARS  
**2**  
WARRANTY

### Product Parameter

|                       |                                |                 |                 |
|-----------------------|--------------------------------|-----------------|-----------------|
| Input Voltage         | DC 3.2V                        | DC 3.2V         | DC 3.2V         |
| LED QTY               | SMD 3030-55pcs                 | SMD 3030-105pcs | SMD 3030-155pcs |
| CCT                   | 6500-7500K                     |                 |                 |
| Luminous Flux         | 900-1500lm                     | 1200-1600lm     | 2000-2600lm     |
| Luminous Efficacy     | 130-150lm/w                    |                 |                 |
| CRI                   | ≥70Ra                          |                 |                 |
| Beam Angle            | 140°x75°                       |                 |                 |
| Battery Type          | LiFePO4                        |                 |                 |
| Battery Capacity      | 3.2V/15AH                      | 3.2V/20AH       | 3.2V/30AH       |
| Panel Type            | Monocrystalline silicon        |                 |                 |
| Solar Panel           | 6V/20W                         | 6V/30W          | 6V/40W          |
| Charging Time         | 4-6H                           | 4-6H            | 4-6H            |
| Operating Time        | 8-12H                          | 8-12H           | 8-12H           |
| IP                    | IP66                           |                 |                 |
| Features              | Remote control + light control |                 |                 |
| Material              | ABS body + PC Lens             |                 |                 |
| Adapt to light pole   | φ63mm                          |                 |                 |
| Lamp Size(mm)         | 625x235x75mm                   | 700x300x81mm    | 820x300x81mm    |
| PCS/CTN               | 5                              | 5               | 5               |
| Carton Size(mm)       | 645x425x250mm                  | 730x460x315mm   | 840x460x320mm   |
| Warranty              | 2 Years                        |                 |                 |
| Operating Temperature | -20°C ~50°C                    |                 |                 |



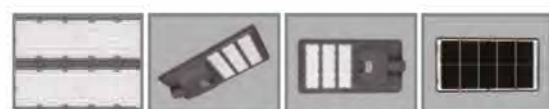
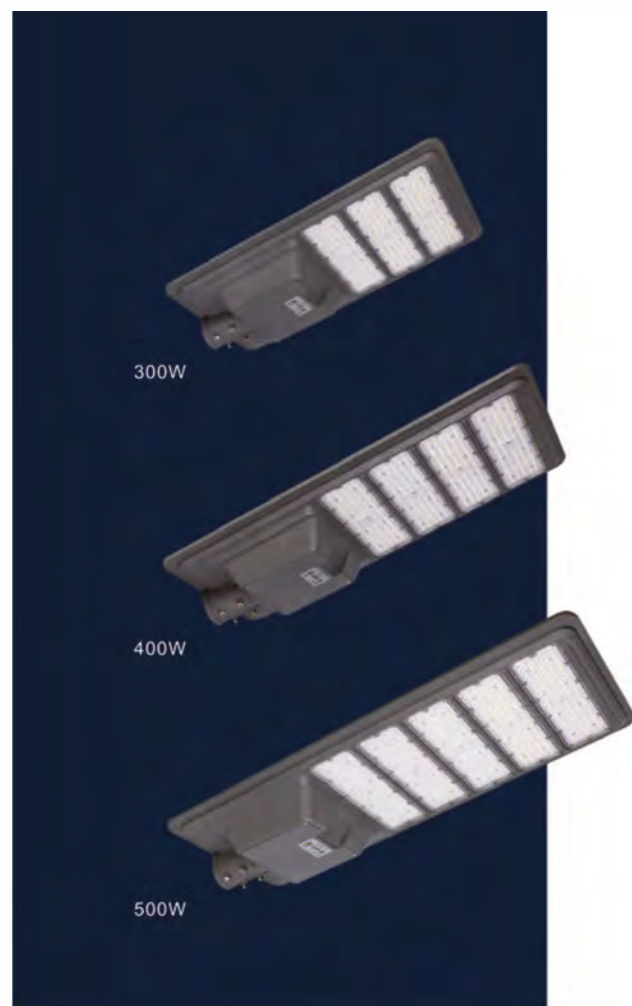

### Dimensions

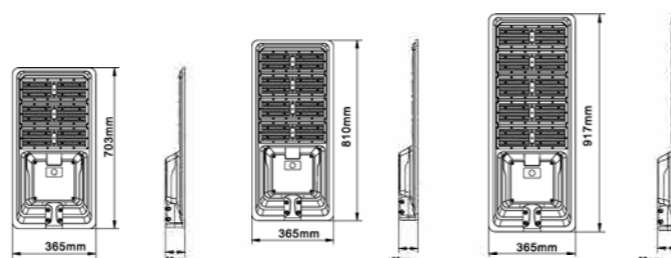

### KEY ADVANTAGES

- Die-cast aluminium body for durable construction
- Green lighting solution powered by solar energy
- Integral design with high-transmittance optical lens
- No need for wiring, ready to use
- IP 65 tightness level, water-proof & dust-proof

### Luminance Intensity Distribution

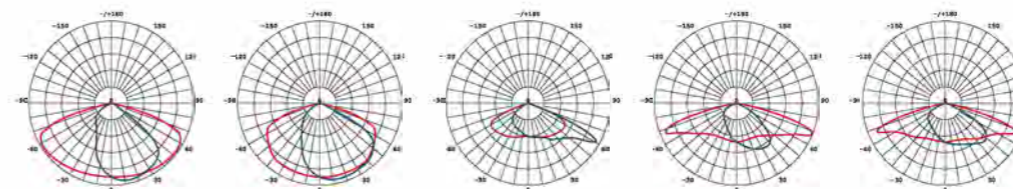

### Product Parameter

|                       |                              |                 |                |
|-----------------------|------------------------------|-----------------|----------------|
| Lighting Pattern      | Light control+remote control |                 |                |
| LED QTY               | 306pcs SMD3030               | 408pcs SMD 3030 | 510pcs SMD3030 |
| CCT                   | 6000-6500k                   |                 |                |
| Luminous Flux         | 6000lm                       | 7000lm          | 8000lm         |
| Luminous Efficacy     | 150lm/w                      |                 |                |
| CRI                   | ≥ 70Ra                       |                 |                |
| Beam Angle            | 140°x75°                     |                 |                |
| Battery Type          | LiFePO4                      |                 |                |
| Battery Capacity      | 3.2V/35AH                    | 3.2V/40AH       | 3.2V/45AH      |
| Panel Type            | Monocrystalline silicon      |                 |                |
| Solar Panel           | 5V/40W                       | 4.5V/45W        | 5V/53W         |
| Charging Time         | 4-6H                         | 4-6H            | 4-6H           |
| Operating Time        | 12-18H                       | 12-18H          | 12-18H         |
| Material              | Die-cast Aluminium + PC Lens |                 |                |
| IP                    | IP65                         |                 |                |
| Installation Height   | 5-6m                         | 6-8m            | 7-10m          |
| Lamp Size(mm)         | 703x365x86                   | 810x365x86      | 917x365x86     |
| PCS/CTN               | 1                            | 1               | 1              |
| Carton Size(mm)       | 770x415x130                  | 865x415x130     | 970x415x130    |
| Net Weight(kg)        | 2.72                         | 2.98            | 3.38           |
| Gross Weight(kg)      | 3.5                          | 3.7             | 4              |
| Warranty              | 2 Years                      |                 |                |
| Operating Temperature | -20°C ~50°C                  |                 |                |



## KEY ADVANTAGES

- Green lighting solution powered by solar energy
- Integral design with high-transmittance optical lens
- No need for wiring, ready to use
- 90° adjustable lamp adaptor for convenience
- High efficiency solar panel and quality LiFePO4 battery



## Dimensions

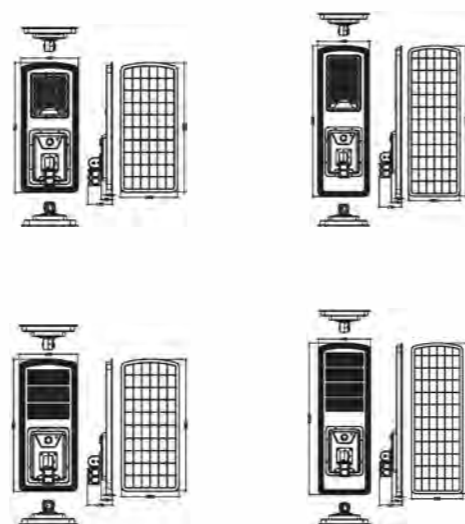

## Luminance Intensity Distribution

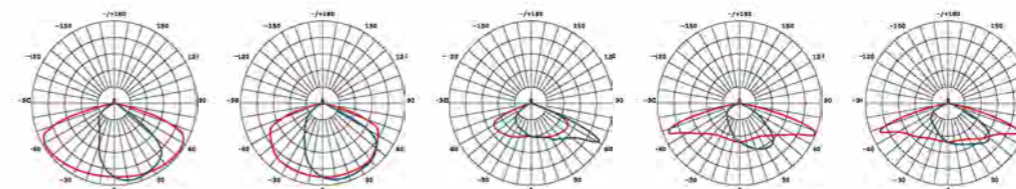

TWO YEARS  
**2**  
WARRANTY

## Product Parameter

|                         |                         |                |
|-------------------------|-------------------------|----------------|
| Model Name              |                         |                |
| Input Voltage           | DC 3.2V                 | DC 3.2V        |
| LED QTY                 | 150pcs SMD5050          | 200pcs SMD5050 |
| CCT                     | 6000-6500K              |                |
| Luminous Flux           | 3000lm                  | 4000lm         |
| Luminous Efficacy       | 180-190lm/w             |                |
| CRI                     | ≥ 70Ra                  |                |
| Beam Angle              | 140°x75°                |                |
| Battery Type            | LiFePO4                 |                |
| Battery Capacity        | 3.2V/66AH               | 3.2V/88AH      |
| Panel Type              | Monocrystalline silicon |                |
| Solar Panel             | 4.5V/70W                | 4.5V/90W       |
| Charging Time           | 4-6H                    | 4-6H           |
| Operating Time          | 8-12H                   | 8-12H          |
| Material                | Die-cast Aluminum       |                |
| Adapt to Light Pole(mm) | φ 60/80mm(optional)     |                |
| Lamp Size(mm)           | 910x400x280             | 1168x400x280   |
| PCS/CTN                 | 1                       | 1              |
| Carton Size(mm)         | 1060X450X140            | 1320X450X140   |
| Warranty                | 2 Years                 |                |
| Operating Temperature   | -20°C ~50 °C            |                |



### Dimensions

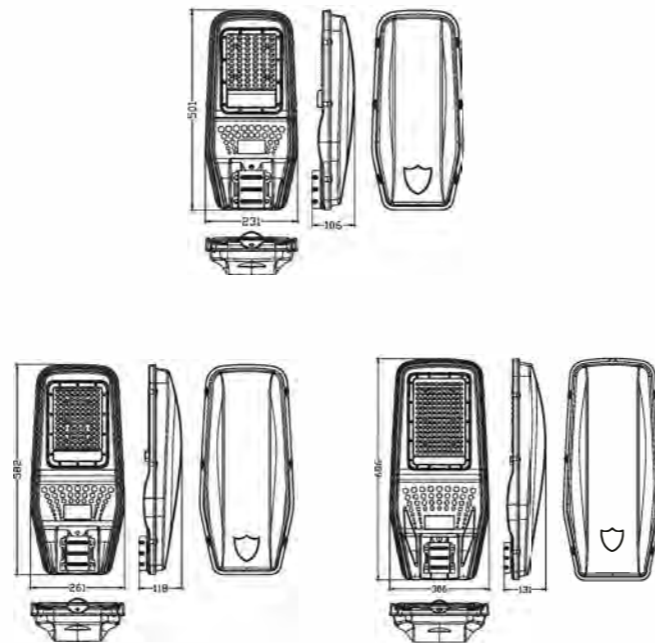

### KEY ADVANTAGES

- Cost effective and efficient lighting solution
- Green lighting solution powered by solar energy
- High luminous efficiency for enhanced lumination
- No need for wiring, ready to use
- IP65 tightness level, water-proof & dust-proof

### Luminance Intensity Distribution

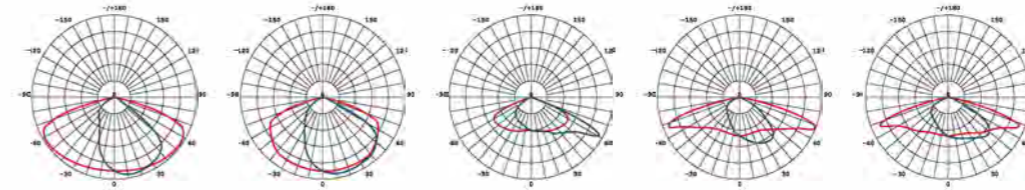

### Product Parameter

| Model Name            |                              |                |                |
|-----------------------|------------------------------|----------------|----------------|
| Power                 | 20W                          | 30W            | 40W            |
| Lighting Pattern      | Light control+remote control |                |                |
| LED QTY               | 60pcs SMD5050                | 100pcs SMD5050 | 150pcs SMD5050 |
| CCT                   | 6000-6500k                   |                |                |
| Luminous Flux         | 1800-2800lm                  | 3000-4200lm    | 4000-5000lm    |
| Luminous Efficacy     | 180-190lm/w                  |                |                |
| CRI                   | ≥ 70Ra                       |                |                |
| Beam Angle            | 80°x150°                     |                |                |
| Battery Type          | LiFePO4                      |                |                |
| Battery Capacity      | 3.2V/44AH                    | 3.2V/66AH      | 3.2V/88AH      |
| Panel Type            | Polycrystalline silicon      |                |                |
| Solar Panel           | 6V/50W                       | 6V/70W         | 6V/100W        |
| Charging Time         | 4-6H                         | 4-6H           | 4-6H           |
| Operating Time        | 8-12H                        | 8-12H          | 8-12H          |
| Material              | Die-cast Aluminium + PC Lens |                |                |
| IP                    | IP65                         |                |                |
| Installation Height   | 9-12m                        | 9-12m          | 9-12m          |
| Lamp Size(mm)         | 500x230x90                   | 580x250x100    | 688x307x120    |
| PCS/CTN               | 1                            | 1              | 1              |
| Carton Size(mm)       | 520x240x115                  | 610x275x120    | 700x320x125    |
| Warranty              | 2 Years                      |                |                |
| Operating Temperature | -20°C ~50°C                  |                |                |



### Luminance Intensity Distribution

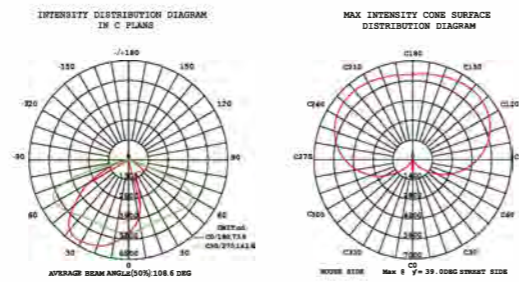

### Dimensions

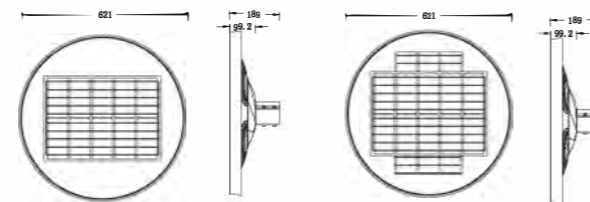

### KEY ADVANTAGES

- Die-cast aluminium body for robust construction
- Green lighting solution powered by solar energy
- No need for wiring, ready to use
- High efficiency solar panel and quality LiFePO4 battery
- IP 65 tightness level, water-proof & dust-proof



### Product Parameter

|                         |  |             |
|-------------------------|--|-------------|
| Model Name              |  |             |
| LED TYPE                | SMD5054                                  |             |
| LED QTY                 | 104pcs                                   | 104pcs      |
| CCT                     | 6000K-6500K                              |             |
| Luminous Flux           | 3,000lm                                  | 4,000lm     |
| Luminous Efficiency     | 100-110lm/w                              |             |
| CRI                     | ≥ 70Ra                                   |             |
| Beam Angle              | 120°                                     |             |
| Battery Type            | LiFePO4                                  |             |
| Battery Capacity        | 3.2V/25AH                                | 3.2V/35AH   |
| Panel Type              | Monocrystalline silicon                  |             |
| Solar Panel             | 5V/25W                                   | 5V/35W      |
| Charging Time           | 4-6H                                     |             |
| Operating Time          | 2-3 rainy days                           |             |
| Material                | Die-cast Aluminum+Tempered Glass+PC Lens |             |
| IP                      | IP65                                     |             |
| Lifetime                | 50000H                                   |             |
| Adapt to Light Pole(mm) | Φ 76mm                                   |             |
| Lamp Size(mm)           | 620x620x189                              | 620x620x189 |
| Carton Size(mm)         | 625x625x130                              | 625x625x130 |
| PCS/CTN                 | 1  | 1           |
| Net Weight(kg)          | 6.45                                     | 6.65        |
| Gross Weight(kg)        | 7.84                                     | 7.94        |
| Warranty                | 2 Years                                  |             |
| Operating Temperature   | -15°C ~45°C                              |             |



### Luminance Intensity Distribution

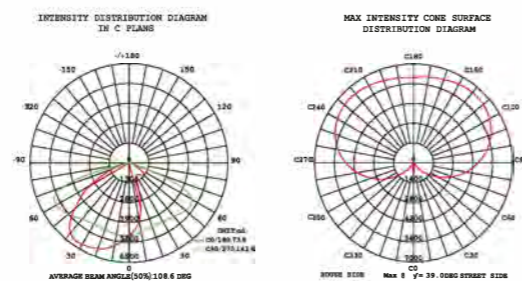

### Dimensions

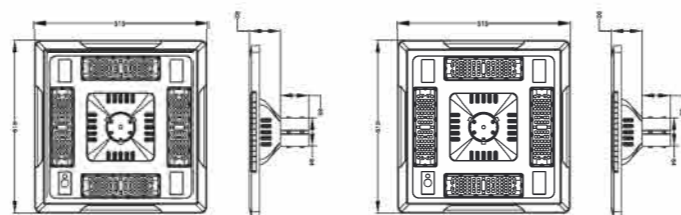

### KEY ADVANTAGES

- Die-cast aluminium body for robust construction
- Green lighting solution powered by solar energy
- No need for wiring, ready to use
- High efficiency solar panel and quality LiFePO4 battery
- IP 65 tightness level, water-proof & dust-proof



### Product Parameter

|                         |  |             |
|-------------------------|--|-------------|
| Model Name              |  |             |
| LED TYPE                | SMD3030                                  |             |
| LED QTY                 | 256pcs                                   | 256pcs      |
| CCT                     | 6000K-6500K                              |             |
| Luminous Flux           | 3,000Lm                                  | 4,000lm     |
| Luminous Efficiency     | 100-110lm/w                              |             |
| CRI                     | ≥ 70Ra                                   |             |
| Beam Angle              | 70-140°                                  |             |
| Battery Type            | LiFePO4                                  |             |
| Battery Capacity        | 3.2V/25AH                                | 3.2V/35AH   |
| Panel Type              | Monocrystalline silicon                  |             |
| Solar Panel             | 5V/25W                                   | 5V/35W      |
| Charging Time           | 4-6H                                     |             |
| Operating Time          | 2-3 rainy days                           |             |
| Material                | Die-cast Aluminum+Tempered Glass+PC Lens |             |
| IP                      | IP65                                     |             |
| Lifetime                | 50000H                                   |             |
| Adapt to Light Pole(mm) | 76mm                                     |             |
| Lamp Size(mm)           | 515x515x177                              | 515x515x177 |
| Carton Size(mm)         | 535x535x160                              | 535x535x160 |
| PCS/CTN                 | 1  | 1           |
| Net Weight(kg)          | 5.25                                     | 5.52        |
| Gross Weight(kg)        | 6.52                                     | 6.87        |
| Warranty                | 2 Years                                  |             |
| Operating Temperature   | -15°C ~45°C                              |             |



### KEY ADVANTAGES

- Green lighting solution powered by solar energy
- No need for wiring, ready to use
- Adjustable bracket for multiple installation ways
- High efficiency solar panel and quality LiFePO4 battery
- Light control + remote control available

### Luminance Intensity Distribution

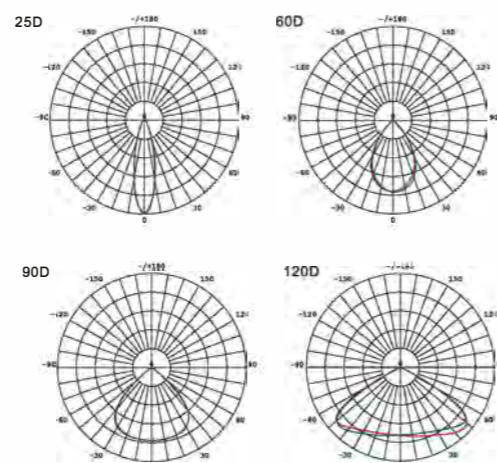

### Dimensions

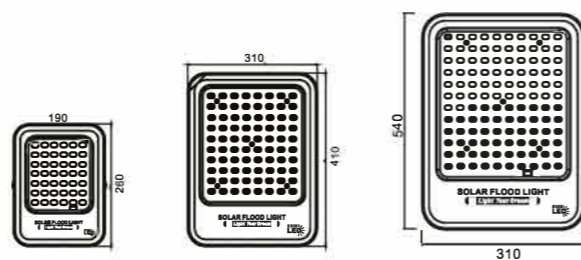

### Product Parameter

|                                  |  |               |                |                         |                |                |                |               |
|----------------------------------|--|---------------|----------------|-------------------------|----------------|----------------|----------------|---------------|
| Model Name                       |  |               |                |                         |                |                |                |               |
| Light Source                     | BRIGELUX/EPISTAR/SANAN/LUMILEDS/CREE(optional) |               |                |                         |                |                |                |               |
| LED QTY                          | 96pcs SMD2835                                  | 96pcs SMD2835 | 160pcs SMD2835 | 160pcs SMD2835          | 160pcs SMD2835 | 120pcs SMD5054 | 120pcs SMD5054 |               |
| CCT                              | 6000-6500K                                     |               |                |                         |                |                |                |               |
| Luminous Flux                    | 700lm  | 1,200lm       | 1,800lm        | 2,500lm                 | 2,500lm        | 4,500lm        | 4,500lm        |               |
| CRI                              | ≥ 80Ra   |               |                |                         |                |                |                |               |
| Beam Angle                       | 90°  |               |                |                         |                |                |                |               |
| Battery Type                     | LiFePO4  |               |                |                         |                |                |                |               |
| Battery Capacity                 | 3.2V/10AH                                      | 3.2V/20AH     | 3.2V/30AH      | 3.2V/40AH               | 3.2V/40AH      | 3.2V/60AH      | 3.2V/60AH      |               |
| Panel Type                       | Polycrystalline Silicon                        |               |                | Monocrystalline silicon |                |                |                |               |
| Solar Panel                      | 5V/12W   | 5V/25W        | 5V/35W         | 5V/50W                  | 5V/50W         | 5W/70W         | 5W/70W         |               |
| Charging Time                    | 4-5H   |               |                |                         |                |                |                |               |
| Operating Time                   | 8-24H  |               |                |                         |                |                |                |               |
| Material                         | Die-cast Aluminum                              |               |                |                         |                |                |                |               |
| IP                               | IP66   |               |                |                         |                |                |                |               |
| Lamp Size(mm)                    | 260x190x55                                     | 260x190x55    | 335x250x65     | 335x250x65              | 460x250x65     | 410x310x70     | 540x310x70     |               |
| Panel Size(mm)                   | 350x290x17                                     | 530x350x17    | 630x350x17     | 700x390x17              | 700x390x17     | 760x520x25     | 760x520x25     |               |
| Gross Weight(kg)<br>(Lamp+Panel) | 24   | 26            | 24             | 32.8                    | 18/25          | 18/19.8        | 20.3/19.8      |               |
| Packing Size<br>(mm)             | Lamp   | 455x450x335mm | 550x270x440mm  | 675x395x270mm           | 560x395x400mm  | 730x420x170mm  | 490x325x425mm  | 480x335x570mm |
|                                  | Panel  | 8 sets/ctn    | 6 sets/ctn     | 4 sets/ctn              | 4 sets/ctn     | 6 sets/ctn     | 5 sets/ctn     | 5 sets/ctn    |
| Warranty                         | 2 Years  |               |                |                         |                |                |                |               |
| Operating Temperature            | -10°C~45°C                                     |               |                |                         |                |                |                |               |
| Accessory                        | Remote controller + mounting brackets          |               |                |                         |                |                |                |               |

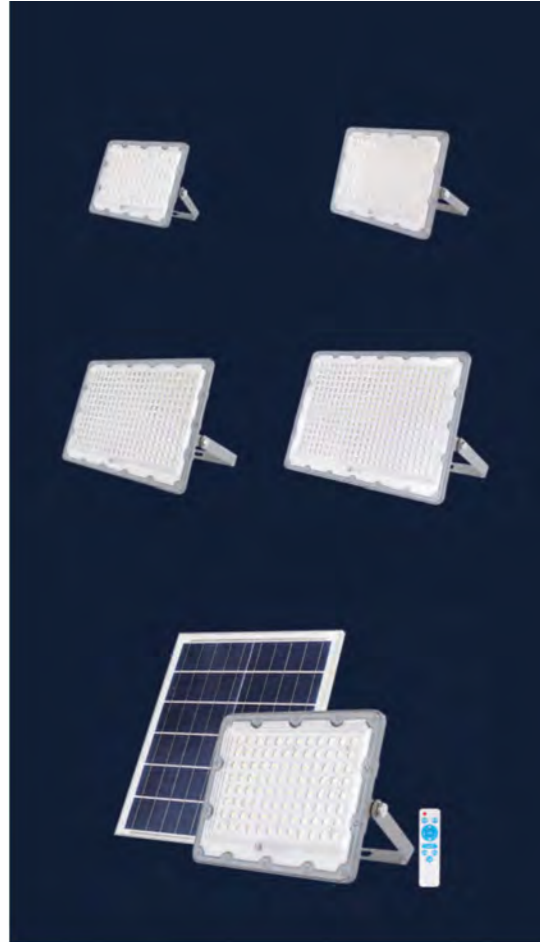

## KEY ADVANTAGES

- One to one replacement for 50 to 500W
- Cost effective and efficient lighting solution
- One design for esthetic consistency in multi-purpose applications
- Maximised saving in energy and maintenance
- Wide inclination angle adjustable on site
- Wide range of operating temperature
- Wide range of colour temperature

## Dimensions

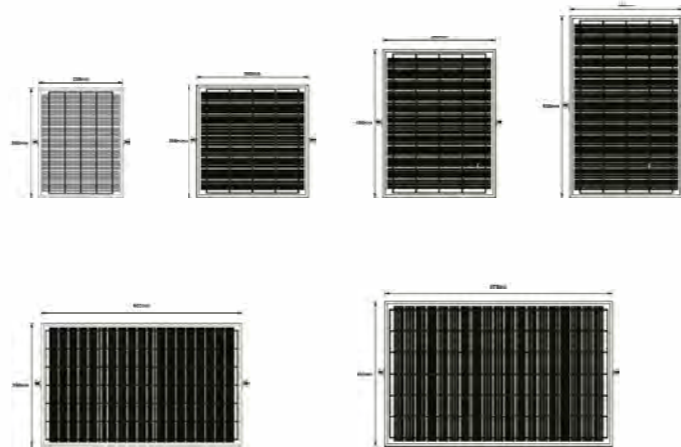
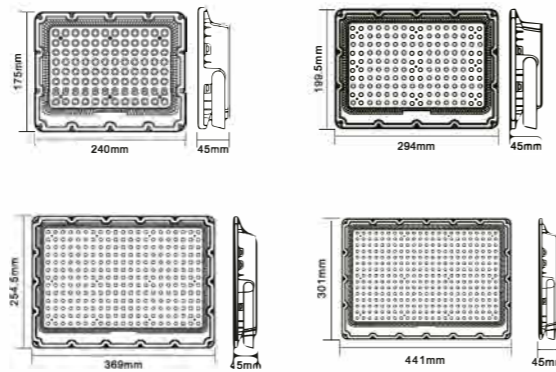

## Luminance Intensity Distribution

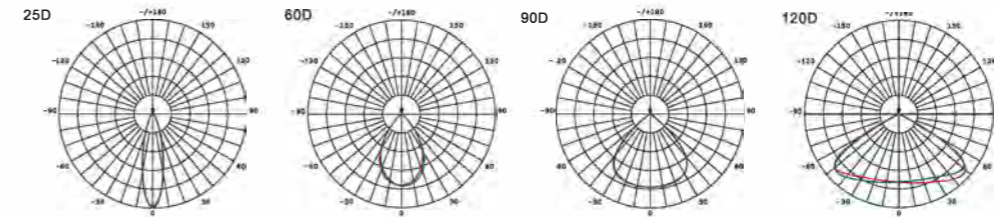

TWO YEARS  
**2**  
WARRANTY  
**>180LM/W**

## Product Parameter

|                       |  |                |                |                |                |                |               |
|-----------------------|--|----------------|----------------|----------------|----------------|----------------|---------------|
| Model Name            |  |                |                |                |                |                |               |
| Light Source          | BRIGELUX/EPISTAR/SANAN/LUMILEDS/CREE(optional)       |                |                |                |                |                |               |
| LED QTY               | 96pcs SMD2835  | 160pcs SMD2835 | 273pcs SMD2835 | 273pcs SMD2835 | 345pcs SMD2835 | 345pcs SMD2835 |               |
| CCT                   | 3000-6500K   |                |                |                |                |                |               |
| Luminous Flux         | 600lm  | 1,200lm        | 2,300lm        | 3,000lm        | 3,800lm        | 4,500lm        |               |
| Luminous Efficacy     | 180lm/w(maximum)                                     |                |                |                |                |                |               |
| CRI                   | ≥ 80Ra   |                |                |                |                |                |               |
| Beam Angle            | 90°  |                |                |                |                |                |               |
| Battery Type          | LiFePO4  |                |                |                |                |                |               |
| Battery Capacity      | 3.2V/6AH   | 3.2V/15AH      | 3.2V/25AH      | 3.2V/30AH      | 3.2V/40AH      | 3.2V/50AH      |               |
| Panel Type            | Polycrystalline Silicon                              |                |                |                |                |                |               |
| Solar Panel           | 5V/8W  | 5V/15W         | 5V/20W         | 5V/30W         | 5V/40W         | 5W/50W         |               |
| Charging Time         | 4-6H   |                |                |                |                |                |               |
| Operating Time        | 2 rainy days   |                |                |                |                |                |               |
| Material              | ADC 12 Die-cast Aluminum                             |                |                |                |                |                |               |
| IP                    | IP65   |                |                |                |                |                |               |
| Lamp Size(mm)         | 240x175x45   | 294x198.5x45   | 369x254.5x45   | 369x254.5x45   | 441x301x45     | 441x301x45     |               |
| Panel Size(mm)        | 235x350x17   | 350x350x17     | 450x350x17     | 600x350x17     | 670x445x20     | 535x670x25     |               |
| Net Weight(kg)        | 2.2  | 3.3            | 4.8            | 5.2            | 8              | 8.8            |               |
| Gross Weight(kg)      | 2.4  | 3.5            | 5              | 5.4            | 8.2            | 9              |               |
| Packing Size (mm)     | Lamp   | 580x390x290mm  | 580x390x390mm  | 580x480x400mm  | 580x390x300mm  | 590x460x350mm  | 580x460x350mm |
|                       | Panel  | 6 sets/ctn     | 6 sets/ctn     | 6 sets/ctn     | 10pcs/ctn      | 10pcs/ctn      | 10pcs/ctn     |
|                       |  |                |                |                | 625x360x390mm  | 710x270x490mm  | 710x270x580mm |
|                       |  |                |                |                | 10pcs/ctn      | 5pcs/ctn       | 5pcs/ctn      |
| Warranty              | 2 Years  |                |                |                |                |                |               |
| Operating Temperature | -10°C ~45°C  |                |                |                |                |                |               |
| Accessory             | Remote control, 1m wires with solid copper connector |                |                |                |                |                |               |



# LED GARDEN LIGHT



## APPLICATIONS



URBAN & RESIDENTIAL STREETS  
BIKE & PEDESTRIAN PATHS  
SQUARES & PEDESTRIAN AREAS  
CAR PARKS  
BRIDGES  
RAILWAY STATIONS & METROS

## PRODUCT FEATURES

- Perfect replacement for traditional lights.
- Save 80% electricity cost, better efficiency, longer life span.
- Dedicated Ip65 sealed optical cavities.
- Optically optimized lenses.
- Uniformity in light distribution-maximizes efficiency.
- Fully operational in extreme weather up -35°C to +55°C.
- Low maintenance & Low power consumption.





### Luminance Intensity Distribution

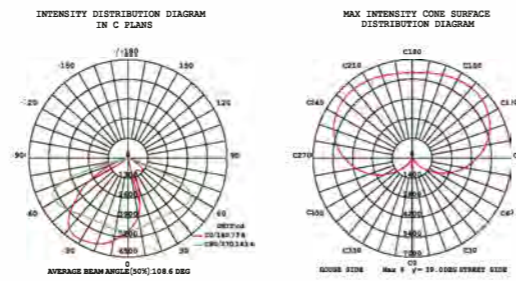

### Dimensions

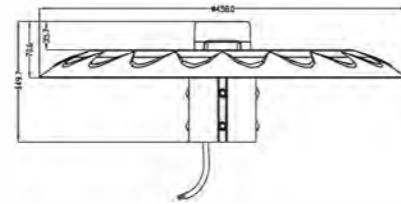

50W/100W

### KEY ADVANTAGES

- Cost-effective and efficient lighting solution
- Die-cast aluminium body for robust construction
- Optimized housing design for good heat dissipation
- High-brightness LED, energy saving
- IP 65 tightness level, water-proof & dust-proof

THREE YEARS  
**3**  
WARRANTY  
>110LM/W

### Product Parameter

|                       |  |                |
|-----------------------|--|----------------|
| Model Name            |  |                |
| Power                 | 50W  | 100W           |
| Light Source          | BRIGELUX/EPISTAR/SANAN/LUMILEDS/CREE(optional) |                |
| LED QTY               | 60pcs SMD3030                                  | 120pcs SMD3030 |
| CCT                   | 6000-6500K                                     |                |
| Luminous Flux         | 5,500lm  | 11,000lm       |
| Luminous Efficacy     | 110-120lm/w                                    |                |
| CRI                   | ≥70Ra  |                |
| Light Distribution    | 120°   |                |
| Protection Class      | Class I  |                |
| Input Voltage         | AC100-305V                                     |                |
| Frequency             | 50/60HZ  |                |
| Power Factor          | 0.95   |                |
| Lifetime              | 30,000H  |                |
| Surge protection      | 4KV(+10KV optional)                            |                |
| THD                   | ≤ 15%  |                |
| Power Efficiency      | ≥ 85%  |                |
| Material              | Die-cast Aluminium Body + PC Lens              |                |
| IP                    | IP65   |                |
| IK                    | IK08   |                |
| Lamp Size(mm)         | φ458mm*H150mm                                  | φ458mm*H150mm  |
| Lamp Weight(kg)       | 2.2  | 2.2            |
| PCS/CTN               | 5  | 5              |
| Carton Size           | 540x515x530                                    | 540x515x530    |
| Net Weight(kg)        | 11   | 11             |
| Gross Weight(kg)      | 14   | 14             |
| Operating Temperature | -25°C ~40°C                                    |                |
| Warranty              | 3 Years Warranty                               |                |



### Luminance Intensity Distribution

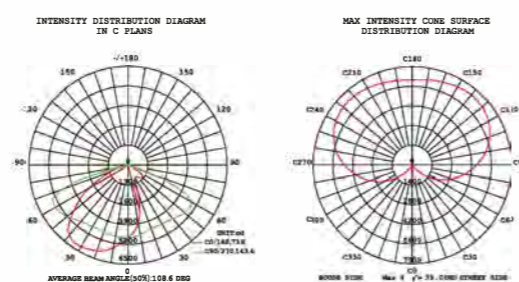

### Dimensions

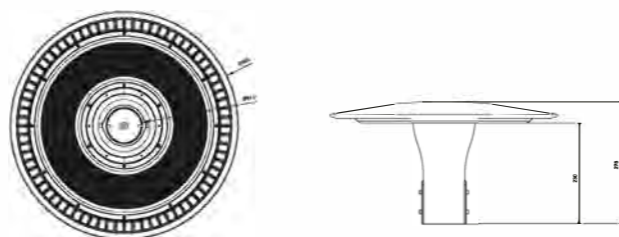

### KEY ADVANTAGES

- Cost-effective and efficient lighting solution
- Die-cast aluminium body for robust construction
- Optimized housing design for good heat dissipation
- High-brightness LED, energy saving
- IP 65 tightness level, water-proof & dust-proof



### Product Parameter

| Model Name            | 40W  | 60W     | 80W     | 100W     |
|-----------------------|--|---------|---------|----------|
| Power                 | 40W  | 60W     | 80W     | 100W     |
| Light Source          | BRIGELUX/EPISTAR/SANAN/LUMILEDS/CREE(optional) |         |         |          |
| CCT                   | 3000-6500K                                     |         |         |          |
| Luminous Flux(lm)     | 4,800lm  | 7,200lm | 9,600lm | 12,000lm |
| Luminous Efficacy     | 120lm/w  |         |         |          |
| CRI                   | ≥ 70Ra   |         |         |          |
| Light Distribution    | 130°   |         |         |          |
| Protection Class      | Class I  |         |         |          |
| Input Voltage         | AC90-305V                                      |         |         |          |
| Frequency             | 50/60HZ  |         |         |          |
| Power Factor          | 0.9  |         |         |          |
| Lifetime              | 50,000H  |         |         |          |
| Surge protection      | 4KV(+10KV optional)                            |         |         |          |
| Control Method        | 0-10V dimming/Photocell(optional)              |         |         |          |
| Adapt to light pole   | φ81  |         |         |          |
| Material              | Die-cast Aluminium Body + PC Lens              |         |         |          |
| IP                    | IP65   |         |         |          |
| IK                    | IK08   |         |         |          |
| Lamp Size(mm)         | 518.7x518.7x277.5                              |         |         |          |
| Lamp Weight(kg)       | 5.4  |         |         |          |
| PCS/CTN               | 1  |         |         |          |
| Carton Size(mm)       | 550x550x293                                    |         |         |          |
| Net Weight(kg)        | 5.4  |         |         |          |
| Gross Weight(kg)      | 6.2  |         |         |          |
| Operating Temperature | -35°C ~55°C                                    |         |         |          |
| Warranty              | 5 Years Warranty                               |         |         |          |



### Luminance Intensity Distribution

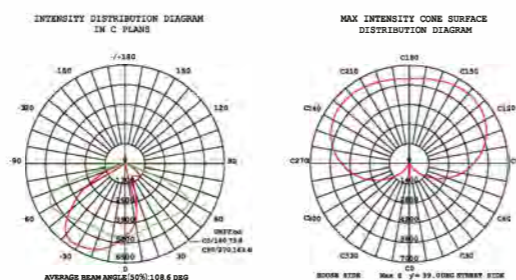

### Dimensions

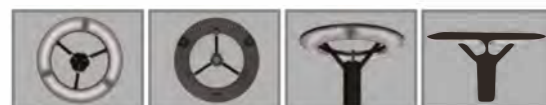
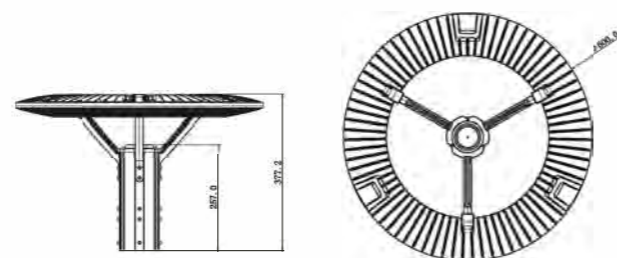

### KEY ADVANTAGES

- Cost-effective and efficient lighting solution
- Die-cast aluminium body for robust construction
- Optimized housing design for good heat dissipation
- High-brightness LED, energy saving
- IP 65 tightness level, water-proof & dust-proof

FIVE YEARS  
**5**  
WARRANTY  
>120LM/W

### Product Parameter

|                       | 40W  | 60W     | 80W     | 100W     |
|-----------------------|--|---------|---------|----------|
| Power                 | 40W  | 60W     | 80W     | 100W     |
| Light Source          | BRIGELUX/EPISTAR/SANAN/LUMILEDS/CREE(optional) |         |         |          |
| CCT                   | 3000-6500K                                     |         |         |          |
| Luminous Flux(lm)     | 4,800lm  | 7,200lm | 9,600lm | 12,000lm |
| Luminous Efficacy     | 120lm/w  |         |         |          |
| CRI                   | ≥ 70Ra   |         |         |          |
| Light Distribution    | 90°/120°/75°x160°                              |         |         |          |
| Protection Class      | Class I  |         |         |          |
| Input Voltage         | AC90-305V                                      |         |         |          |
| Frequency             | 50/60HZ  |         |         |          |
| Power Factor          | 0.9  |         |         |          |
| Lifetime              | 50,000H  |         |         |          |
| Surge protection      | 4KV(+10KV optional)                            |         |         |          |
| Control Method        | 0-10V dimming/Photocell (optional)             |         |         |          |
| Adapt to light pole   | φ 81   |         |         |          |
| Material              | Die-cast Aluminium Body + PC Lens              |         |         |          |
| IP                    | IP65   |         |         |          |
| IK                    | IK08   |         |         |          |
| Lamp Size(mm)         | 600x600x377.2                                  |         |         |          |
| Lamp Weight(kg)       | 6.5  |         |         |          |
| PCS/CTN               | 1  |         |         |          |
| Carton Size(mm)       | 640x640x418                                    |         |         |          |
| Net Weight(kg)        | 6.8  |         |         |          |
| Gross Weight(kg)      | 7.5  |         |         |          |
| Operating Temperature | -35°C ~55°C                                    |         |         |          |
| Warranty              | 5 Years Warranty                               |         |         |          |

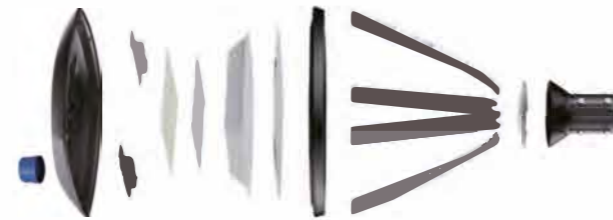

**Luminance Intensity Distribution**

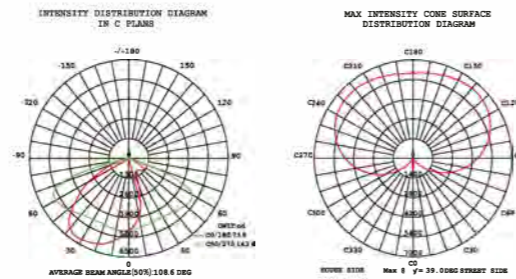

**Dimensions**

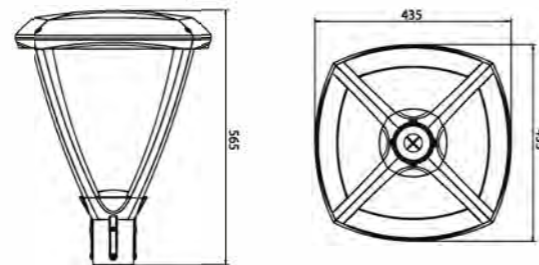

**KEY ADVANTAGES**

- Die-cast aluminium body for robust construction
- Rotating shaft design, easy for installation & maintenance
- Optimized housing design for good heat dissipation
- High-brightness LED, maximized energy saving
- IP 65 tightness level, water-proof & dust-proof



**Product Parameter**

|                       |  |        |        |        |        |         |         |
|-----------------------|--|--------|--------|--------|--------|---------|---------|
| Model Name            |  |        |        |        |        |         |         |
| Power                 | 20W  | 30W    | 40W    | 50W    | 60W    | 80W     | 100W    |
| Light Source          | BRIGELUX/EPISTAR/SANAN/LUMILEDS/CREE(optional) |        |        |        |        |         |         |
| Driver Brand          |  |        |        |        |        |         |         |
| CCT                   | 3000-6500K                                     |        |        |        |        |         |         |
| Luminous Flux         | 2600lm   | 3900lm | 5200lm | 6500lm | 7800lm | 10400lm | 13000lm |
| Luminous Efficacy     | 130lm/w  |        |        |        |        |         |         |
| CRI                   | ≥ 70Ra   |        |        |        |        |         |         |
| Light Distribution    | TYPE I/II/III/IV/V                             |        |        |        |        |         |         |
| Protection Class      | Class I/Class II                               |        |        |        |        |         |         |
| Input Voltage         | AC90-305V                                      |        |        |        |        |         |         |
| Frequency             | 50/60HZ  |        |        |        |        |         |         |
| Power Factor          | 0.95   |        |        |        |        |         |         |
| Lifetime              | 50,000H  |        |        |        |        |         |         |
| Surge protection      | 4KV(+10KV optional)                            |        |        |        |        |         |         |
| Control Method        | 0-10V/Time control available                   |        |        |        |        |         |         |
| Adapt to light pole   | Φ 76   |        |        |        |        |         |         |
| Material              | Die-cast Aluminium Body + PC Lens              |        |        |        |        |         |         |
| IP                    | IP66   |        |        |        |        |         |         |
| IK                    | IK09   |        |        |        |        |         |         |
| Lamp Size(mm)         | 435X435X565                                    |        |        |        |        |         |         |
| Lamp Weight(kg)       | 8,5  |        |        |        |        |         |         |
| PCS/CTN               | 1  |        |        |        |        |         |         |
| Carton Size(mm)       | 550X445X170                                    |        |        |        |        |         |         |
| Net Weight(kg)        | 8.5  |        |        |        |        |         |         |
| Gross Weight(kg)      | 9.4  |        |        |        |        |         |         |
| Operating Temperature | -25°C ~40°C                                    |        |        |        |        |         |         |
| Warranty              | 5 Years Warranty                               |        |        |        |        |         |         |



FIVE YEARS  
**5**  
WARRANTY  
>130LM/W

### Luminance Intensity Distribution

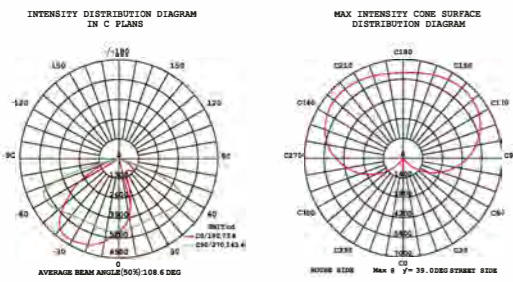

### Dimensions

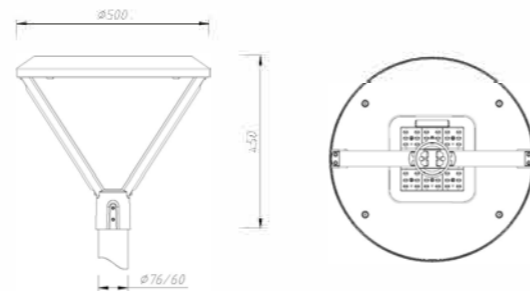

### KEY ADVANTAGES

- Efficient lighting solution
- Wide range of colour temperature
- Housing optimized for heat dissipation and reduce dust accumulation
- Wide range of beam angle (optional)
- Surge protection 6KV (+10Kv optional)
- 4 Mounting Type: Suspended mounted. Pendant mounted  
Side entry mounted. Post top mounted
- IP 66 tightness level

### Product Parameter

|                              |   |                |        |        |        |         |         |
|------------------------------|---|----------------|--------|--------|--------|---------|---------|
| <b>Model Name</b>            |   |                |        |        |        |         |         |
| <b>Power</b>                 | 20W   | 30W            | 40W    | 50W    | 60W    | 80W     | 100W    |
| <b>Light Source</b>          | SANAN/BRIDGELUX/LUMILEDS/CREE(optional)   |                |        |        |        |         |         |
| <b>CCT</b>                   | 6500K (5000K / 4000K / 3000K available)   |                |        |        |        |         |         |
| <b>Luminous Flux</b>         | 2600lm  | 3900lm         | 5200lm | 6500lm | 7800lm | 10400lm | 13000lm |
| <b>Luminous Efficacy</b>     | 130lm/w   |                |        |        |        |         |         |
| <b>CRI</b>                   | Ra70  |                |        |        |        |         |         |
| <b>Light Distribution</b>    | Type II, Type II-B, Type III, Type IV-B, SCL, XW (design according project requirement) |                |        |        |        |         |         |
| <b>LED Driver</b>            |   |                |        |        |        |         |         |
| <b>Input Voltage</b>         | AC90-305V   |                |        |        |        |         |         |
| <b>Frequency</b>             | 50 / 60 Hz  |                |        |        |        |         |         |
| <b>Power Factor</b>          | ≥0.9 at Max load  |                |        |        |        |         |         |
| <b>Power Efficiency</b>      | 0.93  |                |        |        |        |         |         |
| <b>THD</b>                   | <15%  |                |        |        |        |         |         |
| <b>Surge Protection</b>      | 6KV (+10Kv optional)  |                |        |        |        |         |         |
| <b>Control Method</b>        | 0-10V/ TIME CONTROL   |                |        |        |        |         |         |
| <b>Adapt to light pole</b>   | ø32、ø42、ø48、ø60、ø76   |                |        |        |        |         |         |
| <b>Size</b>                  | mm  | 500*500*450    |        |        |        |         |         |
| <b>Weight</b>                | kg  | 6kg            |        | 6kg    |        | 6kg     |         |
| <b>Material</b>              | Body  | ADC12 Aluminum |        |        |        |         |         |
|                              | Optic   | PC             |        |        |        |         |         |
|                              | Cover   | Tempered Glass |        |        |        |         |         |
| <b>IP Rating</b>             | IP66  |                |        |        |        |         |         |
| <b>IK Rating</b>             | IK08  |                |        |        |        |         |         |
| <b>Operating Temperature</b> | -40°C ~ 50°C  |                |        |        |        |         |         |
| <b>Warranty</b>              | 5 Years   |                |        |        |        |         |         |



### Luminance Intensity Distribution

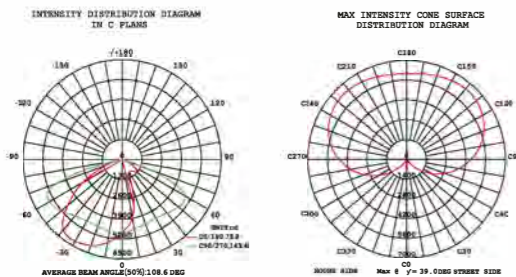

### KEY ADVANTAGES

- Three mountings types: single-arm, twin-arms, adjustable arms
- Die-cast aluminium body for robust construction
- Optimized housing design for good heat dissipation
- High-brightness LED, energy saving
- IP 65 tightness level, water-proof & dust-proof



### Product Parameter

|                       | 30W  | 60W     | 80W      | 100W     | 120W     | 150W     |
|-----------------------|--|---------|----------|----------|----------|----------|
| Power                 | 30W  | 60W     | 80W      | 100W     | 120W     | 150W     |
| Light Source          | BRIGELUX/EPISTAR/SANAN/LUMILEDS/CREE(optional)     |         |          |          |          |          |
| CCT                   | 3000-6500K   |         |          |          |          |          |
| Luminous Flux         | 3,900lm  | 7,800lm | 10,400lm | 13,000lm | 15,600lm | 19,500lm |
| Luminous Efficacy     | 130-140lm/w  |         |          |          |          |          |
| CRI                   | ≥ 70Ra   |         |          |          |          |          |
| Light Distribution    | 90°/120°/75°x160°                                  |         |          |          |          |          |
| Protection Class      | Class I  |         |          |          |          |          |
| Input Voltage         | AC90-305V  |         |          |          |          |          |
| Frequency             | 50/60HZ  |         |          |          |          |          |
| Power Factor          | 0.9  |         |          |          |          |          |
| Lifetime              | 50,000H  |         |          |          |          |          |
| Surge protection      | 4KV(+10KV optional)                                |         |          |          |          |          |
| Control Method        | 0-10V/Time control available                       |         |          |          |          |          |
| Adapt to light pole   | Φ60/Φ75  |         |          |          |          |          |
| Material              | Die-cast Aluminium Body + PC Lens + Tempered Glass |         |          |          |          |          |
| IP                    | IP65   |         |          |          |          |          |
| IK                    | IK08   |         |          |          |          |          |
| Lamp Size(mm)         | Φ 423x520  |         |          |          |          |          |
| Lamp Weight(kg)       | 5  |         |          |          |          |          |
| PCS/CTN               | 1  |         |          |          |          |          |
| Carton Size(mm)       | 580x580x235  |         |          |          |          |          |
| Net Weight(kg)        | 5.15   |         |          |          |          |          |
| Gross Weight(kg)      | 6  |         |          |          |          |          |
| Operating Temperature | -25°C~40°C   |         |          |          |          |          |
| Warranty              | 5 Years Warranty                                   |         |          |          |          |          |

# LED FLOOD LIGHT



## APPLICATIONS



ACCENT & ARCHITECTURAL UNDERPASSES TUNNELS & UNDERPASSES INDUSTRIAL HALLS & WAREHOUSES LARGE AREAS CAR PARKS SPORT AREAS BRIDGES

## PRODUCT FEATURES

- Available in white, warm white and RGB light.
- Premium quality aluminium alloy body.
- Corrosion resistant.
- Fascia glass sealed with silicone rubber ensuring superior waterproof / airtight performance.
- High lumen LED chip SMD or COB.
- Built in constant current driver.
- Better power savings.
- Built in power supply, no external ballast required.

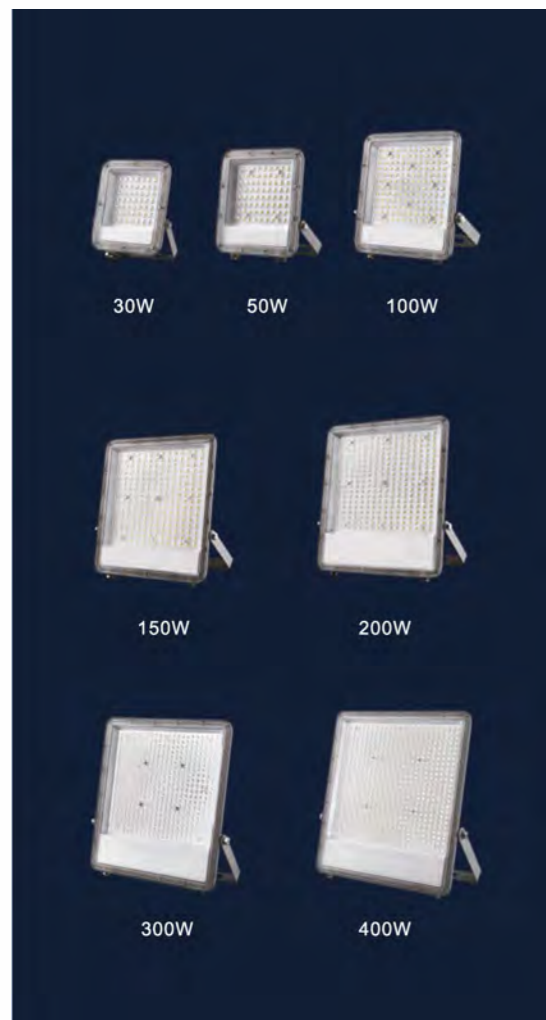

### Luminance Intensity Distribution

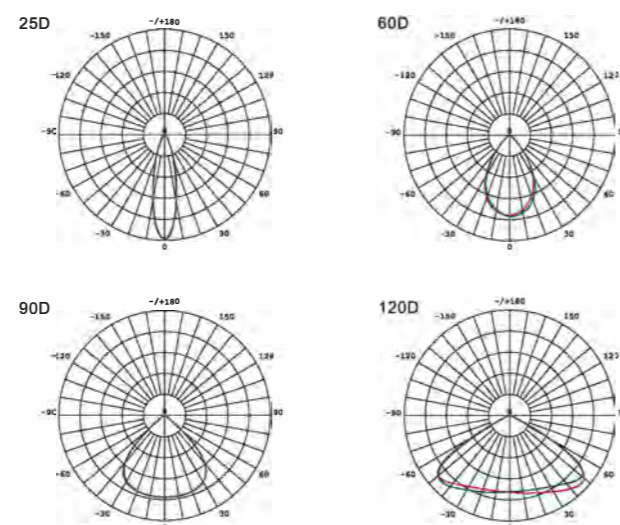

### Dimensions

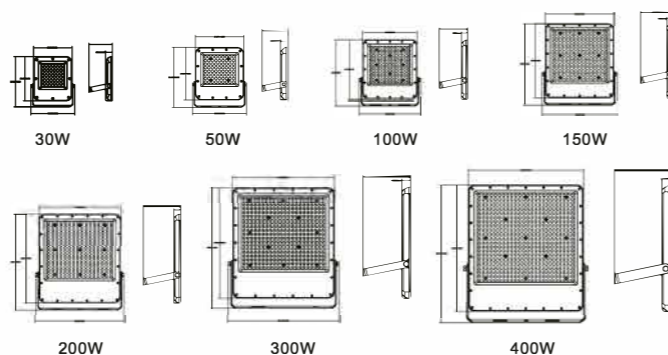

### KEY ADVANTAGES

- Cost-effective and efficient lighting solution
- Compact design, easy to install
- Seven sizes for power 30W-400W, catering for different lighting needs
- IP 65 tightness level, water-proof & dust-proof

**TWO YEARS**  
**2**  
**WARRANTY**  
**>100LM/W**

### Product Parameter

|                       | 30W  | 50W         | 100W        | 150W        | B 200W      | 300W        | 400W        |
|-----------------------|--|-------------|-------------|-------------|-------------|-------------|-------------|
| Power                 | 30W  | 50W         | 100W        | 150W        | B 200W      | 300W        | 400W        |
| Driver Type           | DOB solution                                   |             |             |             |             |             |             |
| Light Source          | BRIGELUX/EPISTAR/SANAN/LUMILEDS/CREE(optional) |             |             |             |             |             |             |
| CCT                   | 2700-6500K                                     |             |             |             |             |             |             |
| Luminous Flux         | 3,300  | 5,500       | 11,000      | 16,500      | 22,000      | 33,000      | 44,000      |
| Luminous Efficacy     | 110lm/w  |             |             |             |             |             |             |
| CRI                   | ≥ 70Ra   |             |             |             |             |             |             |
| Beam Angle            | 90°  |             |             |             |             |             |             |
| Protection Class      | Class I  |             |             |             |             |             |             |
| Input Voltage         | AC100-265V                                     |             |             |             |             |             |             |
| Frequency             | 50/60HZ  |             |             |             |             |             |             |
| Power Factor          | > 0.9  |             |             |             |             |             |             |
| Li fetime             | 25000H   |             |             |             |             |             |             |
| Surge protection      | 4KV(+10KV optional)                            |             |             |             |             |             |             |
| Material              | Die-cast Alumi ni um Body + PC Lens            |             |             |             |             |             |             |
| IP                    | IP65   |             |             |             |             |             |             |
| IK                    | IK08   |             |             |             |             |             |             |
| Lamp Size(mm)         | 160x139x25                                     | 180x165x25  | 238x217x25  | 296x270x25  | 335x305x25  | 378x345x30  | 425x388x31  |
| PCS/CTN               | 20   | 20          | 10          | 10          | 5           | 5           | 5           |
| Carton Size(mm)       | 335x325x205                                    | 385x325x230 | 325x255x290 | 325x305x350 | 340x165x385 | 390x195x435 | 425x200x480 |
| Operating Temperature | -25°C~40°C                                     |             |             |             |             |             |             |
| Warranty              | 3 Years Warranty                               |             |             |             |             |             |             |





## KEY ADVANTAGES

- Cost-effective and efficient lighting solution
- Compact design, easy to install
- Seven sizes for power 10W-400W, catering for different lighting needs
- IP 65 tightness level, water-proof & dust-proof

## Luminance Intensity Distribution

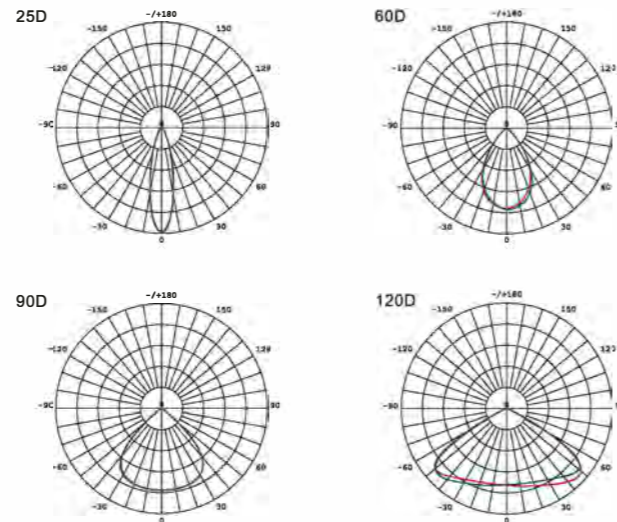

## Dimensions

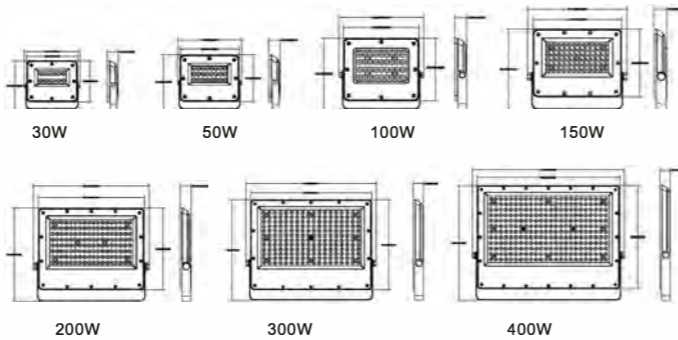

TWO YEARS  
**2**  
WARRANTY  
>100LM/W

## Product Parameter

|                       |  |                   |              |             |             |             |             |             |             |
|-----------------------|--|-------------------|--------------|-------------|-------------|-------------|-------------|-------------|-------------|
| Model Name            |  |                   |              |             |             |             |             |             |             |
| Power                 | 10W  | 20W               | 30W          | 50W         | 100W        | 150W        | 200W        | 300W        | 400W        |
| Driver Type           | DOB solution                                       |                   |              |             |             |             |             |             |             |
| Light Source          | BRI GELLUX/EPI STAR/SANAN/LUMI LEDS/CREE(optional) |                   |              |             |             |             |             |             |             |
| CCT                   | 2700-6500K   |                   |              |             |             |             |             |             |             |
| Luminous Flux         | 1100   | 2200              | 3300         | 5500        | 11000       | 16500       | 22000       | 33000       | 44000       |
| Luminous Efficacy     | 110lm/w  |                   |              |             |             |             |             |             |             |
| CRI                   | ≥70Ra  |                   |              |             |             |             |             |             |             |
| Beam angle            | 90°  |                   |              |             |             |             |             |             |             |
| Protection Class      | Class I  |                   |              |             |             |             |             |             |             |
| Input Voltage         | AC100-265V   |                   |              |             |             |             |             |             |             |
| Frequency             | 50/60HZ  |                   |              |             |             |             |             |             |             |
| Power Factor          | > 0.9  |                   |              |             |             |             |             |             |             |
| Lifetime              | 25000H   |                   |              |             |             |             |             |             |             |
| Surge protection      | 4KV(+10KV optional)                                |                   |              |             |             |             |             |             |             |
| Material              | Die-cast Aluminium body + PC Lens                  |                   |              |             |             |             |             |             |             |
| IP                    | IP65   |                   |              |             |             |             |             |             |             |
| IK                    | IK08   |                   |              |             |             |             |             |             |             |
| Lamp Size(mm)         | 119.8x105.65x23.5                                  | 132.8x112.65x23.5 | 123x148x23.8 | 176x135x25  | 241x185x25  | 300x224x25  | 350x225x25  | 425x315x27  | 470x360x28  |
| PCS/CTN               | 40   | 40                | 20           | 20          | 20          | 10          | 5           | 5           | 5           |
| Carton Size(mm)       | 335x275x260  | 335x295x280       | 345x310x180  | 471x370x195 | 475x370x305 | 362x370x288 | 407x195x318 | 456x195x355 | 505x200x400 |
| Operating Temperature | -25°C~40°C   |                   |              |             |             |             |             |             |             |
| Warranty              | 3 Years Warranty                                   |                   |              |             |             |             |             |             |             |



### Luminance Intensity Distribution

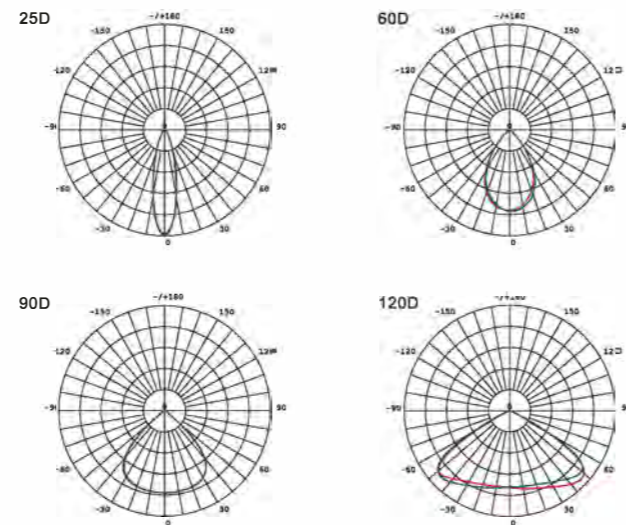

### KEY ADVANTAGES

- Cost effective and efficient lighting solution
- One design for esthetic consistency in multi-purpose applications
- Maximised saving in energy and maintenance
- Wide inclination angle adjustable on site
- Wide range of operating temperature
- Wide range of colour temperature

### Dimensions

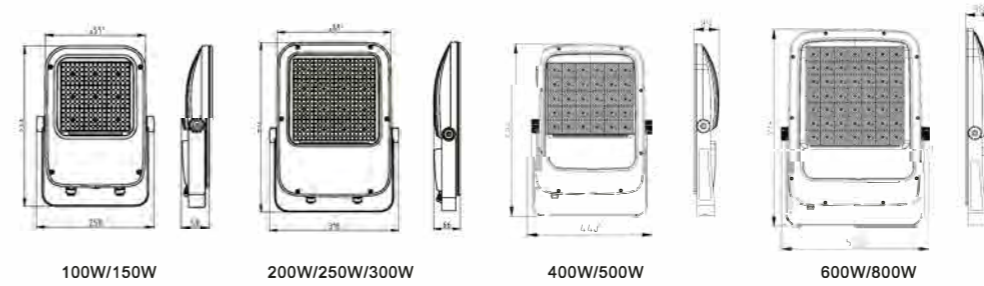

### Product Parameter

| Model Name            |  |                |         |         |            |         |         |            |          |            |  |
|-----------------------|--|----------------|---------|---------|------------|---------|---------|------------|----------|------------|--|
| Power                 | 100W   | 150W           | 200W    | 250W    | 300W       | 400W    | 500W    | 600W       | 800W     |            |  |
| Light Source          | SANAN/BRIDGELUX/LUMILEDS/CREE(optional)                    |                |         |         |            |         |         |            |          |            |  |
| CCT                   | 6500K (5000K / 4000K / 3000K available)                    |                |         |         |            |         |         |            |          |            |  |
| Luminous Flux         | 15000lm  | 22500lm        | 30000lm | 37500lm | 45000lm    | 60000lm | 70000lm | 84000lm    | 112000lm |            |  |
| Luminous Efficacy     | 150LM/W  |                |         |         |            |         |         |            |          |            |  |
| CRI                   | Ra70   |                |         |         |            |         |         |            |          |            |  |
| Light Distribution    | 30° /60° /90° /120° (design according project requirement) |                |         |         |            |         |         |            |          |            |  |
| LED Driver            |  |                |         |         |            |         |         |            |          |            |  |
| Input Voltage         | AC90-277V  |                |         |         |            |         |         |            |          |            |  |
| Frequency             | 50 / 60 Hz   |                |         |         |            |         |         |            |          |            |  |
| Power Factor          | ≥0.95 at Max load  |                |         |         |            |         |         |            |          |            |  |
| Power Efficiency      | 0.93   |                |         |         |            |         |         |            |          |            |  |
| THD                   | <15%   |                |         |         |            |         |         |            |          |            |  |
| Surge Protection      | 4 to 6KV (+10KV optional)                                  |                |         |         |            |         |         |            |          |            |  |
| Control Method        | 0-10V / PWM / TIME CONTROL / DALI                          |                |         |         |            |         |         |            |          |            |  |
| Size                  | mm   | 353X258X58     |         |         | 419X318X66 |         |         | 586X440X89 |          | 714X533X98 |  |
| Weight                | kg   | 3.1kg          | 3.1kg   | 4.7kg   | 4.7kg      | 4.7kg   | 11.9kg  | 11.9kg     | 17.1kg   | 17.1kg     |  |
| Material              | Body   | ADC12 Aluminum |         |         |            |         |         |            |          |            |  |
|                       | Optic  | PC             |         |         |            |         |         |            |          |            |  |
|                       | Cover  | Tempered Glass |         |         |            |         |         |            |          |            |  |
| Finish                | Powder Coating   |                |         |         |            |         |         |            |          |            |  |
| IP Rating             | IP65   |                |         |         |            |         |         |            |          |            |  |
| IK Rating             | IK08   |                |         |         |            |         |         |            |          |            |  |
| Operating Temperature | -35°C ~ 55°C   |                |         |         |            |         |         |            |          |            |  |
| Warranty              | 5 Years  |                |         |         |            |         |         |            |          |            |  |



## KEY ADVANTAGES

- Die-cast aluminium body for robust construction
- Multiple beam angle for selection
- Adjustable bracket, easy to install
- IP 65 tightness level, water-proof & dust-proof

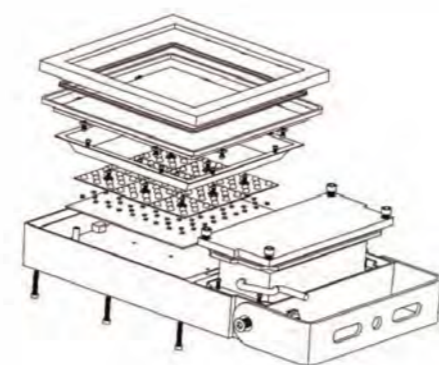

## Luminance Intensity Distribution

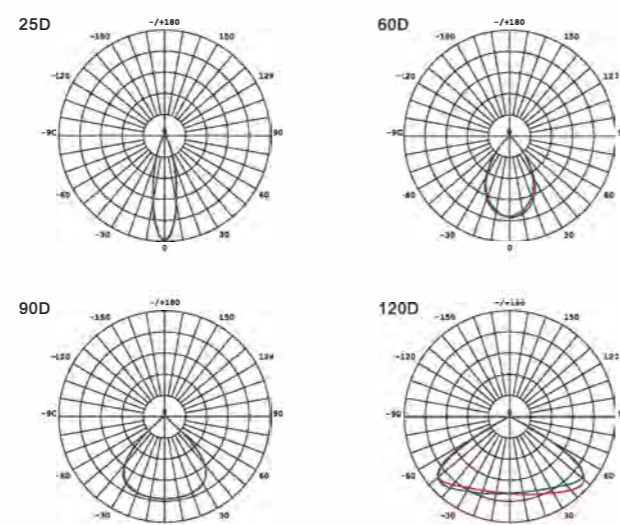

## Dimensions

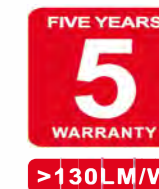
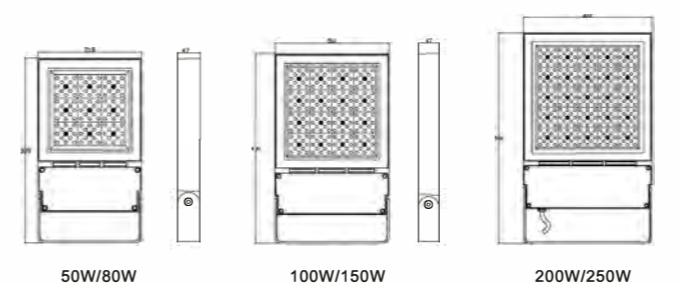

## Product Parameter

|                       |  |          |             |          |             |          |
|-----------------------|--|----------|-------------|----------|-------------|----------|
| Model Name            |  |          |             |          |             |          |
| Power                 | 50W  | 80W      | 100W        | 150W     | 200W        | 250W     |
| Light Source          | BRIGELUX/EPISTAR/SANAN/LUMI LEADS/CREE(optional)   |          |             |          |             |          |
| Driver Brand          |  |          |             |          |             |          |
| CCT                   | 2700-6500K   |          |             |          |             |          |
| Luminous Flux         | 6,500lm  | 10,400lm | 13,000lm    | 19,500lm | 26,000lm    | 32,500lm |
| Luminous Efficacy     | 130lm/w  |          |             |          |             |          |
| CRI                   | ≥ 70Ra   |          |             |          |             |          |
| Light Distribution    | 30°/ 60°/ 90° /120 °                               |          |             |          |             |          |
| Protection Class      | Class I  |          |             |          |             |          |
| Input Voltage         | AC100-265V   |          |             |          |             |          |
| Frequency             | 50/60HZ  |          |             |          |             |          |
| Power Factor          | 0.9  |          |             |          |             |          |
| Lifetime              | 50,000H  |          |             |          |             |          |
| Surge protection      | 4-6KV(+10KV optional)                              |          |             |          |             |          |
| Material              | Die-cast Aluminium Body + PC Lens + Tempered Glass |          |             |          |             |          |
| IP                    | IP65   |          |             |          |             |          |
| IK                    | IK08   |          |             |          |             |          |
| Lamp Size(mm)         | 389x290x47   |          | 430x261x47  |          | 526x321x50  |          |
| PCS/CTN               | 1  |          | 1           |          | 1           |          |
| Carton Size(mm)       | 455X280X115  |          | 495x320x115 |          | 590x380x115 |          |
| Net Weight(kg)        | 3  | 3        | 4.7         | 4.7      | 6.8         | 6.8      |
| Gross Weight(kg)      | 3.7  | 3.7      | 5.5         | 5.5      | 7.5         | 7.6      |
| Operating Temperature | -25°C ~40°C  |          |             |          |             |          |
| Warranty              | 5 Years Warranty                                   |          |             |          |             |          |



### Luminance Intensity Distribution

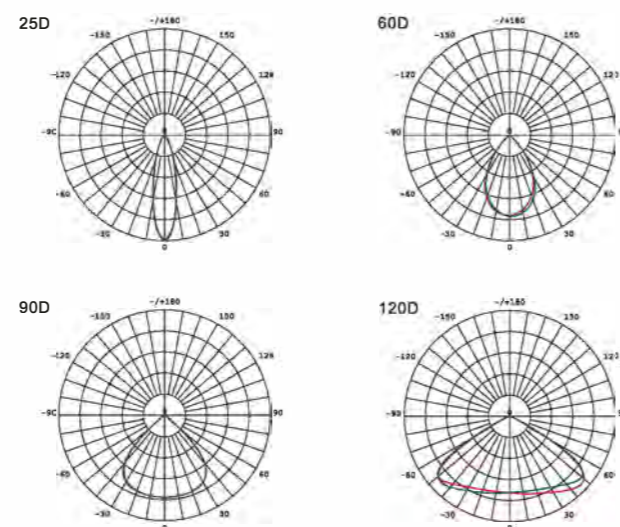

### KEY ADVANTAGES

- Die-cast aluminium body for robust construction
- Ready for smart control to maximize energy savings
- Wide range of beam angle options
- Available in five sizes for 50-300W
- Housing optimized for heat dissipation
- IP 65 tightness level, water-proof & dust-proof

### Dimensions

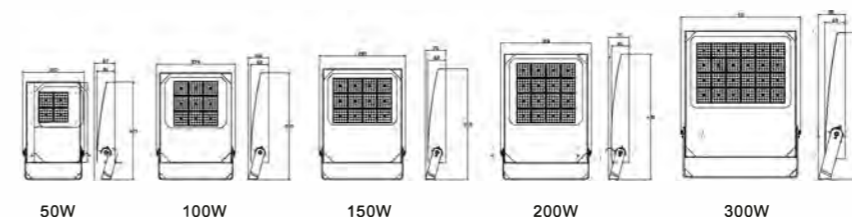

**FIVE YEARS**  
**5**  
**WARRANTY**  
**>155LM/W**

### Product Parameter

| Model Name            | 50W  | 100W        | 150W        | 200W        | 300W        |
|-----------------------|--|-------------|-------------|-------------|-------------|
| Power                 | 50W  | 100W        | 150W        | 200W        | 300W        |
| Driver Type           |  |             |             |             |             |
| Light Source          | BRIGELUX/EPISTAR/SANAN/LUMILEDS/CREE(optional) |             |             |             |             |
| CCT                   | 3000-6000K                                     |             |             |             |             |
| Luminous Flux         | 7,750lm  | 15,500lm    | 23,250lm    | 31,000lm    | 46,500lm    |
| Luminous Efficacy     | 155lm/w  |             |             |             |             |
| CRI                   | ≥ 70Ra   |             |             |             |             |
| Light Distribution    | 30°/60°/90°                                    |             |             |             |             |
| Protection Class      | Class I  |             |             |             |             |
| Input Voltage         | AC100-240V                                     |             |             |             |             |
| Frequency             | 50/60HZ  |             |             |             |             |
| Power Factor          | >0.95  |             |             |             |             |
| Lifetime              | 50000H   |             |             |             |             |
| Surge protection      | 4-6KV(+10KV optional)                          |             |             |             |             |
| Material              | Die-cast Aluminium Body + Tempered Glass       |             |             |             |             |
| IP                    | IP65   |             |             |             |             |
| IK                    | IK08   |             |             |             |             |
| Lamp Size(mm)         | 323x210x61                                     | 355x270x62  | 375x294x62  | 430x310x62  | 490x411x70  |
| PCS/CTN               | 1  | 1           | 1           | 1           | 1           |
| Carton Size(mm)       | 380x250x90                                     | 410x310x100 | 450x335x100 | 485x355x100 | 565x455x115 |
| Net Weight(kg)        | 2.26   | 3.15        | 3.65        | 4.35        | 7.5         |
| Gross Weight(kg)      | 2.81   | 3.8         | 4.45        | 5.3         | 8.7         |
| Operating Temperature | -25°C ~40°C                                    |             |             |             |             |
| Warranty              | 5 Years Warranty                               |             |             |             |             |

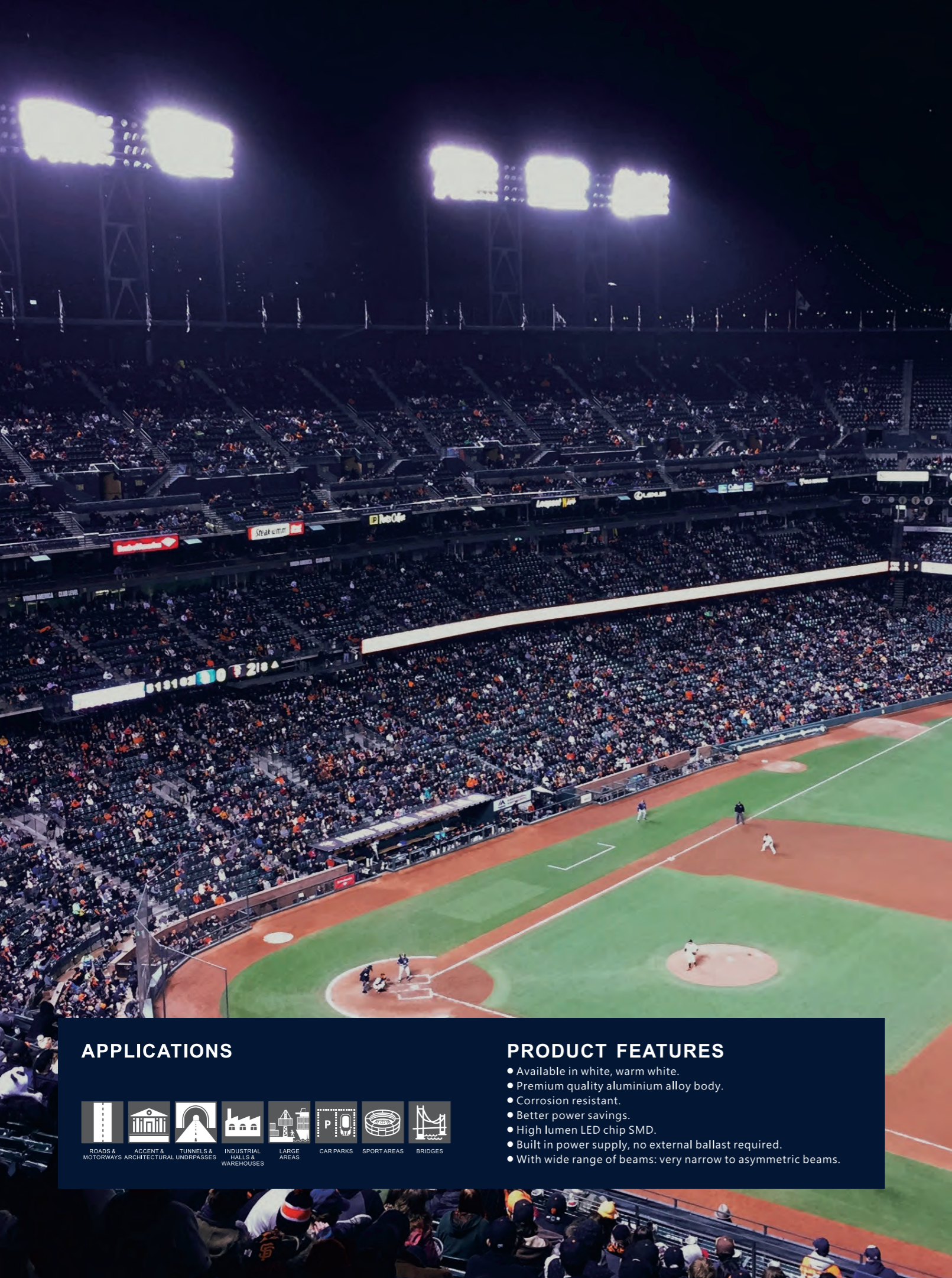

# LED STADIUM LIGHT

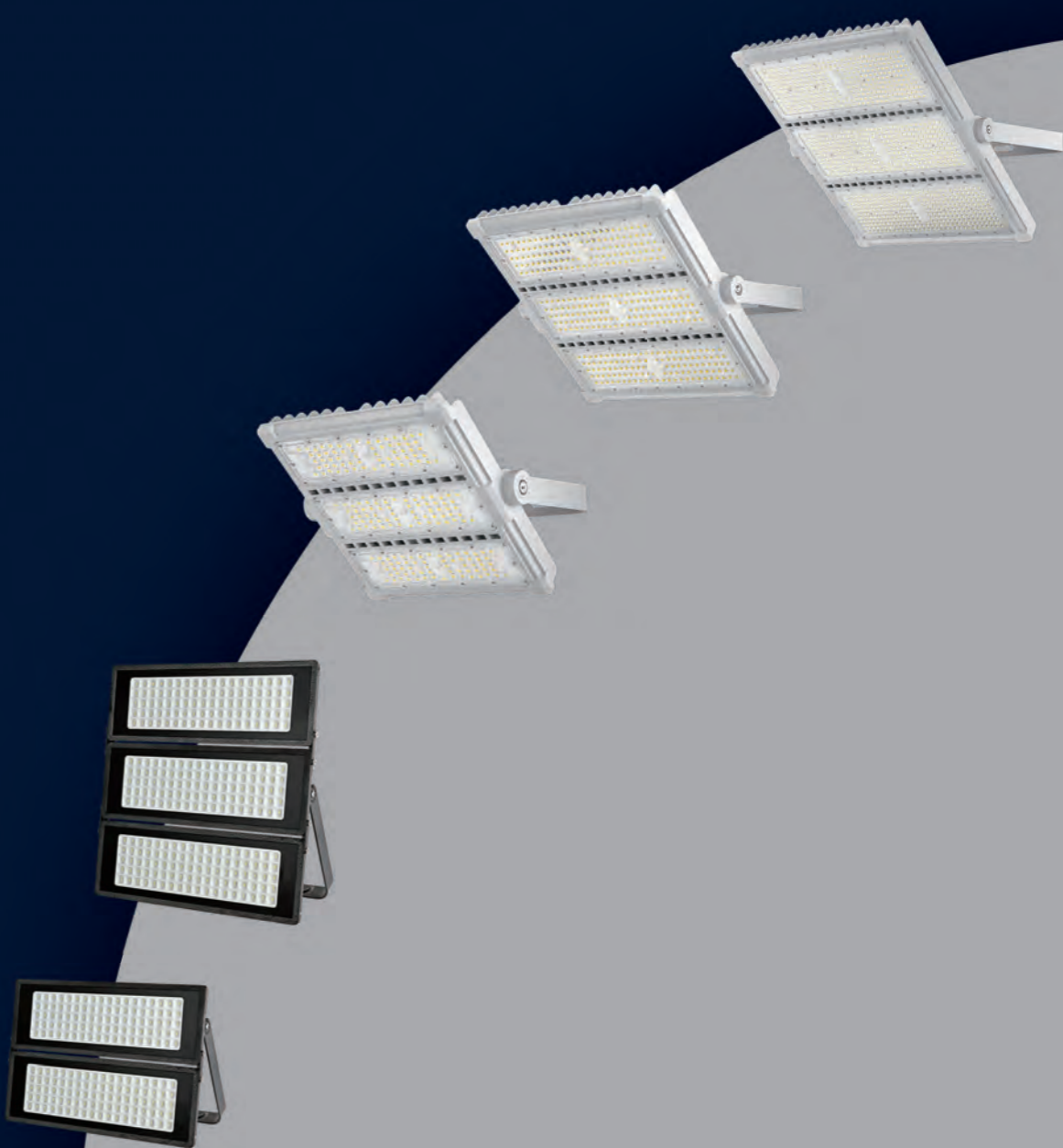

## APPLICATIONS



## PRODUCT FEATURES

- Available in white, warm white.
- Premium quality aluminium alloy body.
- Corrosion resistant.
- Better power savings.
- High lumen LED chip SMD.
- Built in power supply, no external ballast required.
- With wide range of beams: very narrow to asymmetric beams.



### Luminance Intensity Distribution

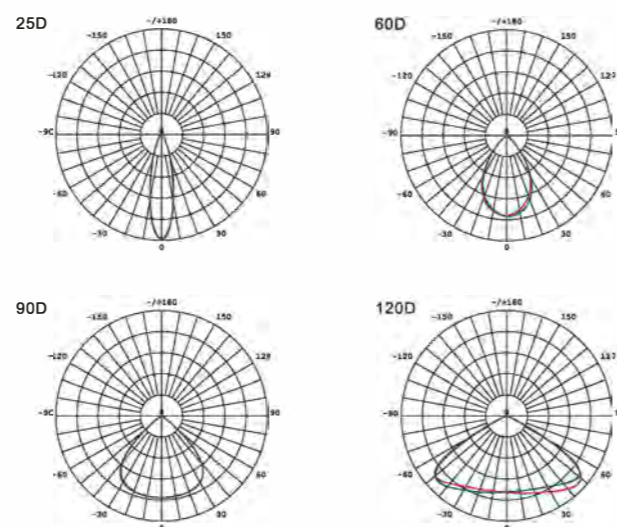

### KEY ADVANTAGES

- Cost-effective and efficient lighting solution
- Die-cast aluminium body for robust construction
- Optimized housing for better heat dissipation
- Four sizes for power 100W-300W, catering for different lighting needs
- IP 66 tightness level, water-proof & dust-proof

**TWO YEARS**  
**2**  
**WARRANTY**  
**>120LM/W**

|                       |  |             |             |             |
|-----------------------|--|-------------|-------------|-------------|
| Model Name            |  |             |             |             |
| Power                 | 100W   | 150W        | 200W        | 300W        |
| LED TYPE              | SMD3030/5050(optional)                         |             |             |             |
| Light Source          | BRIGELUX/EPISTAR/SANAN/LUMILEDS/CREE(optional) |             |             |             |
| Driver                | DOB solution                                   |             |             |             |
| CCT                   | 3000-6500K                                     |             |             |             |
| Luminous Flux         | 12,000lm                                       | 18,000lm    | 24,000lm    | 36,000lm    |
| Luminous Efficacy     | 120lm/w  |             |             |             |
| CRI                   | ≥ 80Ra   |             |             |             |
| Light Distribution    | 90°  |             |             |             |
| Protection Class      | Class I  |             |             |             |
| Input Voltage         | AC95-265V                                      |             |             |             |
| Frequency             | 50/60HZ  |             |             |             |
| Power Factor          | ≥ 0.6  |             |             |             |
| Lifetime              | 8000H  |             |             |             |
| Surge protection      | 4KV(+10KV optional)                            |             |             |             |
| Material              | Die-cast aluminium + PC lens                   |             |             |             |
| IP                    | IP66   |             |             |             |
| IK                    | IK08   |             |             |             |
| Lamp Size(mm)         | 300X105X30                                     | 360X120X30  | 460X135X30  | 510X150X30  |
| PCS/CTN               | 40   | 30          | 24          | 20          |
| Carton Size(mm)       | 440x320x320                                    | 380x320x380 | 480x280x380 | 530x320x320 |
| Net Weight(kg)        | 0.55   | 0.7         | 0.9         | 1.25        |
| Gross Weight(kg)      | 24   | 23          | 24          | 27          |
| Operating Temperature | -30°C~50°C                                     |             |             |             |
| Warranty              | 2 Years Warranty                               |             |             |             |

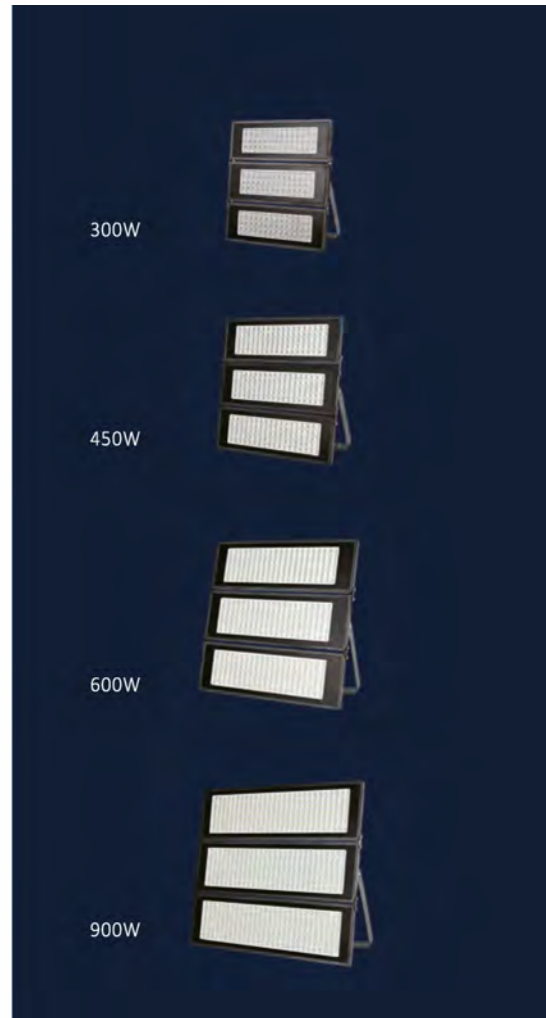

### Luminance Intensity Distribution

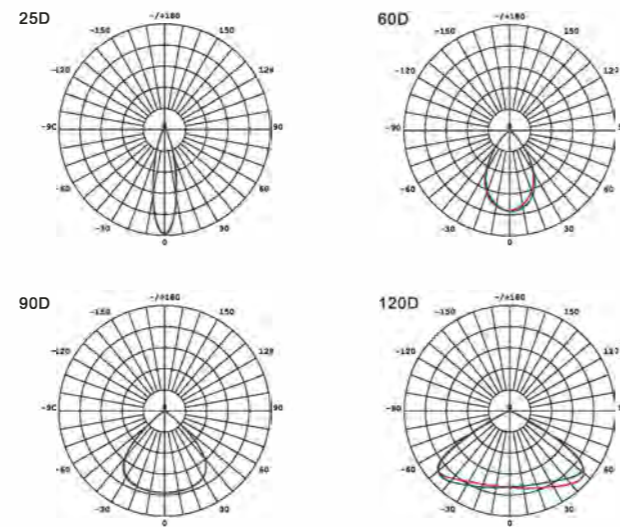

### KEY ADVANTAGES

- Cost-effective and efficient lighting solution
- Die-cast aluminium body for robust construction
- Optimized housing for better heat dissipation
- Wide range of beam angle
- IP 66 tightness level, water-proof & dust-proof

**TWO YEARS**  
**2**  
**WARRANTY**  
**>120LM/W**

|                       |   |             |             |             |
|-----------------------|---|-------------|-------------|-------------|
| Model Name            |   |             |             |             |
| Power                 | 300W  | 450W        | 600W        | 900W        |
| LED TYPE              | SMD3030/5050(optional)                          |             |             |             |
| Light Source          | BRIGELUX/EPistar/SANAN/LUMI LEDs/CREE(optional) |             |             |             |
| Driver                | DOB solution                                    |             |             |             |
| CCT                   | 3000-6500K                                      |             |             |             |
| Luminous Flux         | 36,000lm  | 54,000lm    | 72,000lm    | 108,000lm   |
| Luminous Efficacy     | 120lm/w   |             |             |             |
| CRI                   | ≥ 80Ra  |             |             |             |
| Light Distribution    | 90°   |             |             |             |
| Protection Class      | Class I   |             |             |             |
| Input Voltage         | AC95-265V                                       |             |             |             |
| Frequency             | 50/60HZ   |             |             |             |
| Power Factor          | ≥ 0.6   |             |             |             |
| Lifetime              | 8000H   |             |             |             |
| Surge protection      | 4KV(+10KV optional)                             |             |             |             |
| Material              | Die-cast aluminium + PC lens                    |             |             |             |
| IP                    | IP66  |             |             |             |
| IK                    | IK08  |             |             |             |
| Lamp Size(mm)         | 300x320x55                                      | 360x370x55  | 460x460x55  | 510x460x55  |
| PCS/CTN               | 12  | 10          | 8           | 6           |
| Carton Size(mm)       | 380x320x340                                     | 390x320x380 | 480x260x480 | 530x200x480 |
| Net Weight(kg)        | 1.7   | 2.4         | 3.1         | 4.1         |
| Gross Weight(kg)      | 22.5  | 26          | 27          | 27          |
| Operating Temperature | -30°C~50°C                                      |             |             |             |
| Warranty              | 2 Years Warranty                                |             |             |             |



## KEY ADVANTAGES

- Modular design-50W per module
- Die-cast aluminium body for robust construction
- Optimized heat sink structure for good thermal management
- Multiple beam angle for selection
- Adjustable bracket, multiple installation ways available
- IP 65 tightness level, water-proof & dust-proof

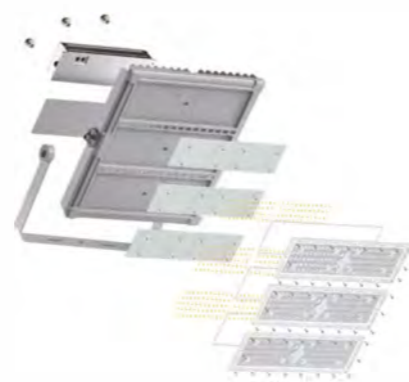

## Luminance Intensity Distribution

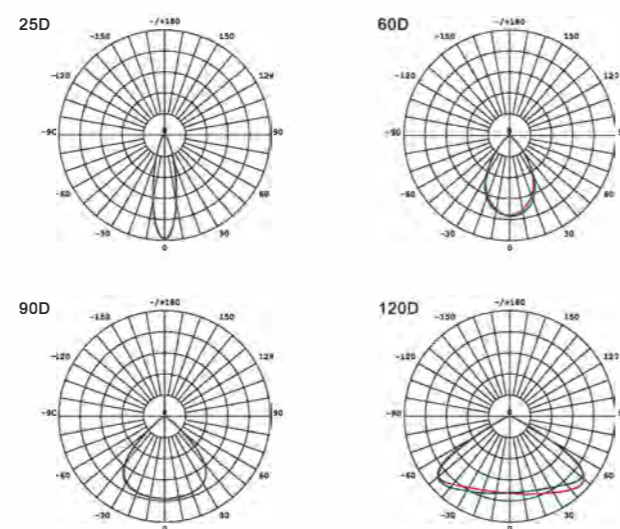

## Dimensions

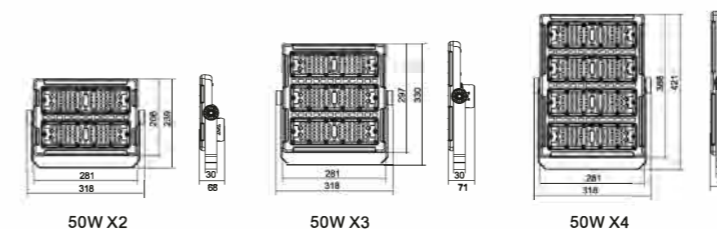

## Product Parameter

|                       |  |             |             |
|-----------------------|--|-------------|-------------|
| Model Name            |  |             |             |
| Power                 | 100W   | 150W        | 200W        |
| Module                | 50Wx2  | 50Wx3       | 50Wx4       |
| LED Driver            | MOSO/INVENTRONICS/MEANWELL (upon request)          |             |             |
| Light Source          | BRIGELUX/EPISTAR/SANAN/LUMILEDS/CREE(optional)     |             |             |
| CCT                   | 3000-6500K   |             |             |
| Luminous Flux         | 13,000lm   | 19,500lm    | 26,000lm    |
| Luminous Efficacy     | 120-130lm/w  |             |             |
| CRI                   | ≥ 70Ra   |             |             |
| Light Distribution    | 30°/60°/90°/75°x160°                               |             |             |
| Protection Class      | Class I  |             |             |
| Input Voltage         | AC90-305V  |             |             |
| Frequency             | 50/60HZ  |             |             |
| Power Factor          | 0.95   |             |             |
| Lifetime              | 50,000H  |             |             |
| Surge protection      | 4KV  | 6KV         | 10KV        |
| Material              | Die-cast Aluminium Body + PC Lens + Tempered Glass |             |             |
| IP                    | IP65   |             |             |
| IK                    | IK08   |             |             |
| Lamp Size(mm)         | 318x239x68   | 318x330x71  | 318x421x71  |
| PCS/CTN               | 1  |             |             |
| Carton Size(mm)       | 320x240x100  | 330x320x105 | 415x320x100 |
| Net Weight(kg)        | 2  | 2.65        | 3.25        |
| Gross Weight(kg)      | 2.5  | 3           | 4           |
| Operating Temperature | -25°C ~40°C  |             |             |
| Warranty              | 5 Years Warranty                                   |             |             |





### Luminance Intensity Distribution

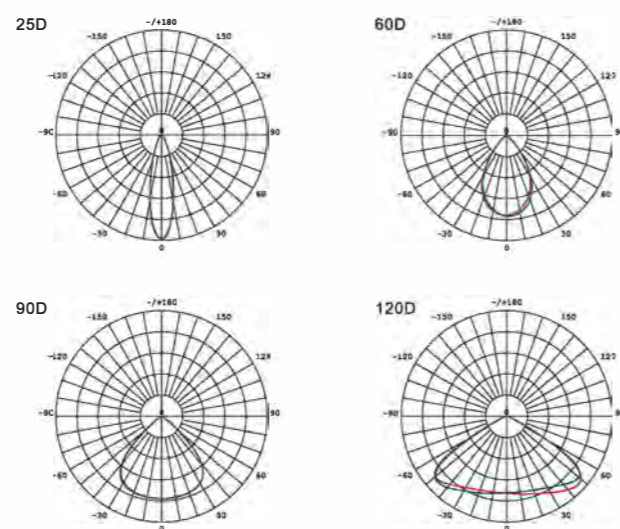

### KEY ADVANTAGES

- Modular design-100W per module
- Die-cast aluminium body for robust construction
- Optimized heat sink structure for good thermal management
- Multiple beam angle for selection
- Adjustable bracket, multiple installation ways available
- IP 65 tightness level, water-proof & dust-proof

### Dimensions

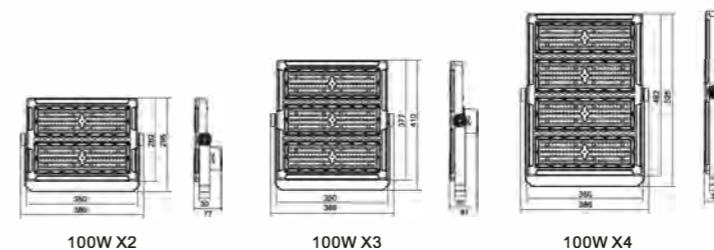

### Product Parameter

|                       |  |             |             |
|-----------------------|--|-------------|-------------|
| Model Name            |  |             |             |
| Power                 | 200W   | 300W        | 400W        |
| Module                | 100Wx2   | 100wx3      | 100wx4      |
| LED Driver            |  |             |             |
| Light Source          | BRIGELUX/EPISTAR/SANAN/LUMILEDS/CREE(optiona       |             |             |
| CCT                   | I) 3000-6500K                                      |             |             |
| Luminous Flux         | 26,000lm   | 39,000lm    | 52,000lm    |
| Luminous Efficacy     | 120-130lm/w  |             |             |
| CRI                   | ≥ 70Ra   |             |             |
| Light Distribution    | 30°/60°/90°/75°x160°                               |             |             |
| Protection Class      | Class I  |             |             |
| Input Voltage         | AC90-305V  |             |             |
| Frequency             | 50/60HZ  |             |             |
| Power Factor          | 0.95   |             |             |
| Lifetime              | 50,000H  |             |             |
| Surge protection      | 4KV  | 6KV         | 10KV        |
| Material              | Die-cast Aluminium Body + PC Lens + Tempered Glass |             |             |
| IP                    | IP65   |             |             |
| IK                    | IK08   |             |             |
| Lamp Size(mm)         | 295X386X77   | 410X386X81  | 525X386X77  |
| PCS/CTN               | 1  |             |             |
| Carton Size(mm)       | 390X295X110  | 410X385X115 | 530x390x110 |
| Net Weight(kg)        | 3.4  | 4.75        | 6.4         |
| Gross Weight(kg)      | 4  | 5           | 7           |
| Operating Temperature | -25°C ~40°C  |             |             |
| Warranty              | 5 Years Warranty                                   |             |             |



400W/500W

600W/750W



### Luminance Intensity Distribution

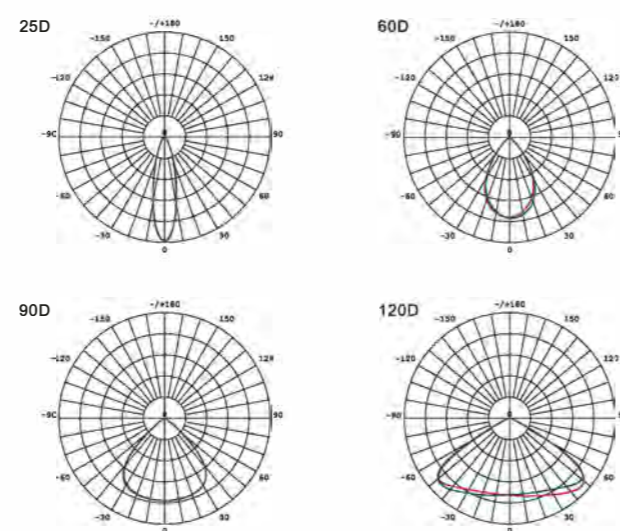

### KEY ADVANTAGES

- Modular design-200/250W per module
- Die-cast aluminium body for robust construction
- Optimized heat sink structure for good thermal management
- Multiple beam angle for selection
- Adjustable bracket, multiple installation ways available
- IP 65 tightness level, water-proof & dust-proof

### Dimensions

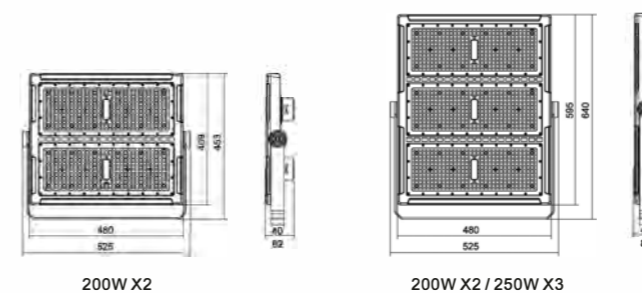

200W X2

200W X2 / 250W X3



### Product Parameter

|                       |  |             |             |             |
|-----------------------|--|-------------|-------------|-------------|
| Model Name            |  |             |             |             |
| Power                 | 400W   | 500W        | 600W        | 750W        |
| Module                | 200Wx2   | 250Wx2      | 200Wx3      | 250Wx3      |
| LED Driver            |  |             |             |             |
| Light Source          | BRIGELUX/EPISTAR/SANAN/LUMILEDS/CREE(optiona       |             |             |             |
| CCT                   | I) 3000-6500K                                      |             |             |             |
| Luminous Flux         | 52,000lm   | 65,000lm    | 78,000lm    | 97,500lm    |
| Luminous Efficacy     | 120-130lm/w  |             |             |             |
| CRI                   | ≥ 70Ra   |             |             |             |
| Light Distribution    | 60°/90°  |             |             |             |
| Protection Class      | Class I  |             |             |             |
| Input Voltage         | AC90-305V  |             |             |             |
| Frequency             | 50/60HZ  |             |             |             |
| Power Factor          | 0.95   |             |             |             |
| Lifetime              | 50,000H  |             |             |             |
| Surge protection      | 4KV  | 6KV         | 10KV        | 10KV        |
| Material              | Die-cast Aluminium Body + PC Lens + Tempered Glass |             |             |             |
| IP                    | IP65   |             |             |             |
| IK                    | IK08   |             |             |             |
| Lamp Size(mm)         | 453X525X82   | 640X525X82  | 453X525X82  | 640X525X82  |
| PCS/CTN               | 1  |             |             |             |
| Carton Size(mm)       | 535X460X115  | 640X535X115 | 535X460X115 | 640X535X115 |
| Net Weight(kg)        | 7.9  | 10.85       | 7.9         | 10.85       |
| Gross Weight(kg)      | 8.5  | 11.5        | 8.5         | 11.5        |
| Operating Temperature | -25°C ~40°C  |             |             |             |
| Warranty              | 5 Years Warranty                                   |             |             |             |

# LED HIGHBAY LIGHT



## APPLICATIONS



SPORT AREAS



INDUSTRIAL HALLS & WAREHOUSES

## PRODUCT FEATURES

- Powerful LED light source with a unique design.
- Extensive options can replace all types of standard MH High bays.
- Shatter Proof Perspex Lens.
- High thermal conductivity, Low luminous decay, pure colors & no heavy shade.
- The unique design of radiator fuses with the lamp box perfectly diffuses the heat conduction efficiently which reduces the temperature of inside lamp & ensures the LED long life span.
- Non -flickering. • No UV radiation.

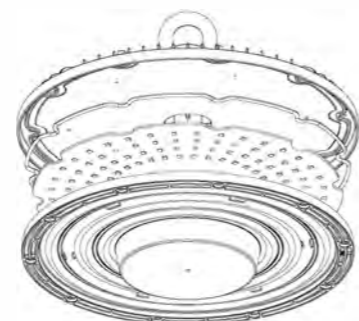

### Luminance Intensity Distribution

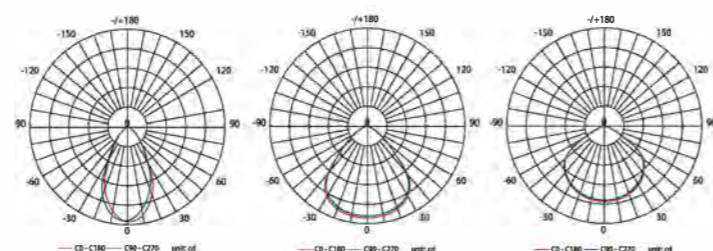

### Dimensions

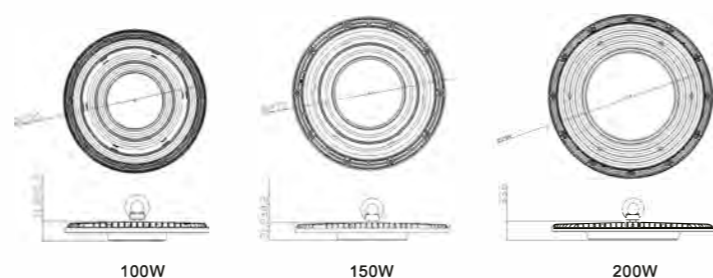

## KEY ADVANTAGES

- Efficient lighting solution
- 3 size to offer the most accurate solution
- Wide range of operating temperature
- Wide range of beam angle (optional)
- Housing optimized for heat dissipation
- Intelligent System Compatible
- IP 65 tightness level

**TWO YEARS**  
**2**  
**WARRANTY**  
**>100LM/W**

### Product Parameter

| Model Name            | 100W                                    | 150W              | 200W       |            |
|-----------------------|---|-------------------|------------|------------|
| Power                 | 100W                                    | 150W              | 200W       |            |
| Light Source          | SANAN/BRIDGELUX/LUMILEDS/CREE(optional) |                   |            |            |
| CCT                   | 6500K (5000K / 4000K / 3000K available) |                   |            |            |
| Luminous Flux         | 10000lm                                 | 15000lm           | 20000lm    |            |
| Luminous Efficacy     | 100LM/W                                 |                   |            |            |
| CRI                   | Ra80                                    |                   |            |            |
| Light Angle           | 60° / 90° / 120°                        |                   |            |            |
| LED Driver            | DOB solution                            |                   |            |            |
| Input Voltage         | AC100-265V                              |                   |            |            |
| Frequency             | 50 / 60 Hz                              |                   |            |            |
| Power Factor          | ≥0.95 at Max load                       |                   |            |            |
| Power Efficiency      | N/A                                     |                   |            |            |
| THD                   | <15%                                    |                   |            |            |
| Surge Protection      | 4KV (+10Kv optional)                    |                   |            |            |
| Control Method        | N/A                                     |                   |            |            |
| Size                  | mm                                      | 230×230×31        | 270×270×31 | 300×300×34 |
| Weight                | kg                                      | 0.7kg             | 0.9kg      | 1.15kg     |
| Material              | Body                                    | Die Cast Aluminum |            |            |
|                       | Optic & Cover                           | PC                |            |            |
| Finish                | Powder Coating                          |                   |            |            |
| IP Rating             | IP65                                    |                   |            |            |
| IK Rating             | IK08                                    |                   |            |            |
| Operating Temperature | -35°C ~ 55°C                            |                   |            |            |
| Warranty              | 2 Years                                 |                   |            |            |



### Luminance Intensity Distribution

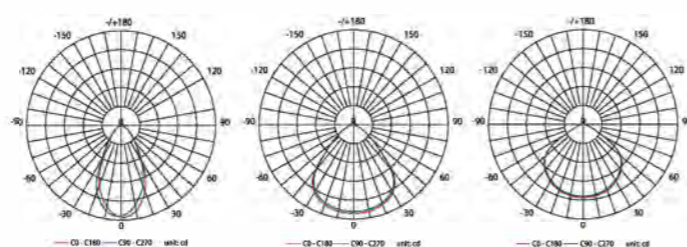

### Dimensions

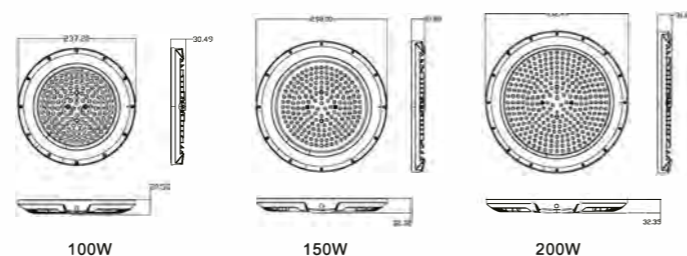

### KEY ADVANTAGES

- Die-cast aluminium body for durable construction
- Compact & lightweight, available in three sizes
- IP 65 tightness level, water-proof & dust-proof
- Perfect for illuminating large spaces with minimal energy consumption

**TWO YEARS**  
**2**  
**WARRANTY**  
**>100LM/W**

### Product Parameter

|                       |  |              |                |
|-----------------------|--|--------------|----------------|
| Model Name            |  |              |                |
| Power                 | 100W   | 150W         | 200W           |
| Light Source          | BRIGELUX/EPISTAR/SANAN/LUMILEDS/CREE(optional) |              |                |
| Driver Type           | DOB solution                                   |              |                |
| CCT                   | 2700-6500K                                     |              |                |
| Luminous Flux(lm)     | 11,000   | 16,500       | 22,000         |
| Luminous Efficacy     | 110lm/w  |              |                |
| CRI                   | Ra70   |              |                |
| Beam Angle            | 90°  |              |                |
| Input Voltage         | 100-265V                                       |              |                |
| Frequency             | 50/60HZ  |              |                |
| Power Factor          | 0.9  |              |                |
| Life Time             | 25,000H  |              |                |
| Surge protection      | 4KV(+10KV optional)                            |              |                |
| Material              | Die-cast aluminium body + PC lens              |              |                |
| Finish                | Powder Coating                                 |              |                |
| IP                    | IP65   |              |                |
| IK                    | IK08   |              |                |
| Lamp Size(mm)         | φ 237.2x30.49mm                                | φ 298x31.8mm | φ 332.4x31.8mm |
| PCS/CTN               | 10   | 10           | 10             |
| Carton Size           | 385x250x255                                    | 405x310x315  | 405x345x350    |
| Operating Temperature | -40°C ~50°C                                    |              |                |
| Warranty              | 3 Years Warranty                               |              |                |

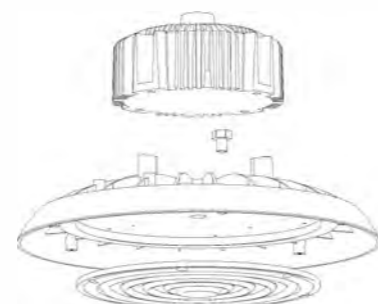

### Luminance Intensity Distribution

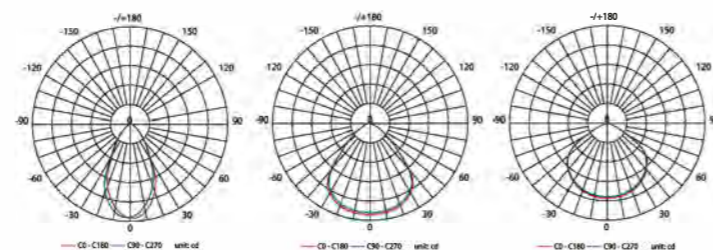

### Dimensions

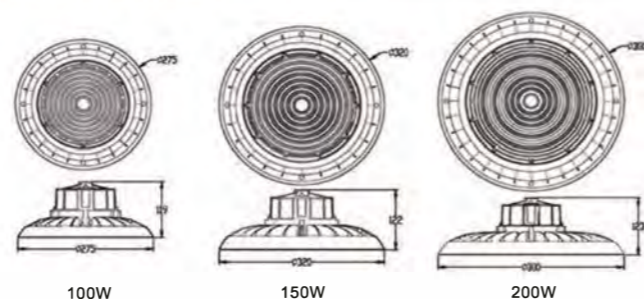

## KEY ADVANTAGES

- High power high bay light, luminous flux up to 85000lm
- 15° 25° Narrow beam angles offer perfect solutions for installation above 20m.
- High energy savings compared to systems with traditional discharge lamps
- Light-on-demand feature with optional motion sensor
- Robust design
- Emergency lighting with optional battery
- High visual comfort
- No hazardous materials
- Fast ROI thanks to long life span and reduced maintenance
- Compact housing optimised for heat dissipation and reduced dust accumulation
- Dedicated range of mounting accessories

### Dimensions

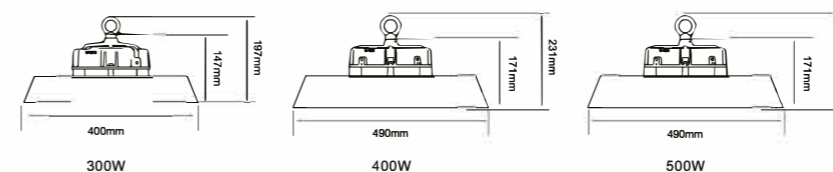

### Product Parameter

| Model Name            | 100W   | 150W           | 200W        | 240W        | 300W        | 400W        | 500W        |
|-----------------------|--|----------------|-------------|-------------|-------------|-------------|-------------|
| Power                 | 100W   | 150W           | 200W        | 240W        | 300W        | 400W        | 500W        |
| Light Source          | SANAN/BRIDGELUX/LUMILEDS/CREE(optional)                                      |                |             |             |             |             |             |
| CCT                   | 6500K (5000K / 4000K / 3000K available)                                      |                |             |             |             |             |             |
| Luminous Flux         | 15000lm  | 22500lm        | 30000lm     | 36000lm     | 45000lm     | 60000lm     | 75000lm     |
| Luminous Efficacy     | 150LM/W  |                |             |             |             |             |             |
| CRI                   | Ra70   |                |             |             |             |             |             |
| Light Angle           | 60° / 90° / 120°   |                |             |             |             |             |             |
| LED Driver            | MEANWELL / MOSO / ZHIHE (can be equipped with customer's local power supply) |                |             |             |             |             |             |
| Input Voltage         | AC90-305V  |                |             |             |             |             |             |
| Frequency             | 50 / 60 Hz   |                |             |             |             |             |             |
| Power Factor          | ≥0.95  |                |             |             |             |             |             |
| Power Efficiency      | 0.93   |                |             |             |             |             |             |
| THD                   | <15%   |                |             |             |             |             |             |
| Surge Protection      | 4 to 6KV (+10Kv optional)  |                |             |             |             |             |             |
| Control Method        | 0-10V / PWM / TIME CONTROL / DALI  |                |             |             |             |             |             |
| Size                  | mm   | 275x275x119    | 320x320x122 | 380x380x123 | 380x380x123 | 400x400x197 | 490x490x231 |
| Weight                | kg   | 2.5kg          | 3.0kg       | 3.5kg       | 3.5kg       | 4.9kg       | 8.5kg       |
| Material              | Body   | ADC12 Aluminum |             |             |             |             |             |
|                       | Optic & Cover  | PC             |             |             |             |             |             |
| Finish                | Powder Coating   |                |             |             |             |             |             |
| IP Rating             | IP66   |                |             |             |             |             |             |
| IK Rating             | IK09   |                |             |             |             |             |             |
| Operating Temperature | -40°C ~ 50°C   |                |             |             |             |             |             |
| Warranty              | 5 Years  |                |             |             |             |             |             |